

**BUDRI** 

COMPANY PROFILE

100% ITALIAN, BY CHOICE

# A STEADY GROWTH



SINCE 1960, BUDRI HAS SPECIALISED IN WORKING FINE MARBLES AND NATURAL STONES. NOW AN ESTABLISHED COMPANY OF WORLD-CLASS RENOWN, BUDRI CONTINUES TO ENJOY STEADY GROWTH, WITH A MANUFACTURING FACILITY OF 8000 M<sup>2</sup>.



AVAILING OF OVER 60 YEARS EXPERIENCE IN BUSINESS, BUDRI SETS THE BENCHMARK FOR THE DESIGN, BESPOKE EXECUTION AND INSTALLATION OF MAJOR PROJECTS OF GREAT COMPLEXITY IN ALL FIVE CONTINENTS.

THE BRAND OCCUPIES A PRIVILEGED POSITION IN NICHE MARKETS WITH HIGH ADDED VALUE, CHARACTERISED BY SUPERIOR PRODUCT QUALITY, BESPOKE PROJECTS AND AN OUTSTANDING LEVEL OF SERVICE DEDICATED TO CLIENTS.

BUDRI IS THE IDEAL PARTNER FOR PROJECTS THAT REQUIRE ITALIAN EXCELLENCE IN CRAFTSMANSHIP, CUTTING-EDGE TECHNOLOGIES AND AN IMPRESSIVE PRODUCTION CAPACITY.















# Focus on Budri



DOLCE & GABBANA CANNES, COYA RESTAURANT DOHA, PRIVATE PENTHOUSE IN MOSCOW, LOUIS VUITTON CAFÉ NAMIKI DORI TOKYO, PRIVATE VILLA COURCHEVEL, PALAZZO AVINO HOTEL RAVELLO, PRIVATE RESIDENCE MODENA; PRIVATE YACHT DOLCE & GABBANA

PRIVATE APARTMENTS: BRERA - MILAN, VIA FIORI OSCURI - MILAN, VIA DELLA MOSCOVA - MILAN, VIA TASSO - MILAN, PIAZZA CASTELLO - MILAN, VIA BIGLI - MILAN; PRIVATE VILLAS: FORTE DEI MARMI, PORTOFINO, SANTA MARGHERITA LIGURE, BEVERLY HILLS, FORTE DEI MARMI, ROQUEBRUNE, MONTECARLO, CAP FERRAT, PHNOM PENH; LUXURY APARTAMENT BUDAPEST; DOLCE & GABBANA DOHA, DOLCE & GABBANA KID DOHA, GIVENCHY SHENZEN, GIVENCHY DOHA, CANALI LONDON, MONCLER CHICAGO, LOUIS VUITTON DOHA.

IN JULY 2022, BUDRI HAS JOINED THE MESTIERI DIVISION OF SOMEK GROUP: A GREAT OPPORTUNITY FOR GROWTH AND SYNERGY WITH A PRESTIGIOUS PARTNER IN THE REALIZATION OF HIGH-END PROJECTS.

PRIVATE VILLAS: PESCARA, FORTE DEI MARMI, VIA MANZONI - MILAN, VIA MOSCOVA - MILAN, FORO BUONAPARTE - MILAN, VIA CANOVA - MILAN; VIA PISACANE, MILAN; P.ZZA CASTELLO - MILAN, VIA F.LLI GABBA - MILAN, PRIVATE RESIDENCE BRESCIA, PRIVATE RESIDENCE HONG KONG.  
OFFICES: D&G VIA KRAMER - MILAN, D&G VIA BELLOTTI - MILAN.  
BOUTIQUES: D&G PLACE VENDOME - DOHA, D&G PRINTEMPS - DOHA, D&G PANAMA CITY, D&G BAKU, D&G MOSCOW, MONCLER CHICAGO, MONCLER MIAMI, GIVENCHY SHENZEN, GIVENCHY PLACE VENDOME - DOHA, TASAKY - MONTECARLO.  
HOTELS & PUBLIC SPACES: CASA BAGLIONI - MILAN, BAR MARTINI - MILAN;  
SPECIAL PROJECT: CHEON WON PALACE, SOUTH KOREA.

SPECIAL PROJECT: PARIS PAVILLON FOR SS 24 RUNAWAY FRENCH FASHION LUXURY BRAND.

PUBLIC SPACES: RH RESTAURANT PARIS

PRIVATE VILLAS: LONDON, GENEVE, SAINT PETERSBURG, BANGALORE, HONG KONG, MILAN - VIA MANZONI. PRIVATE APARTMENTS: LONDON, MILAN, SAN FRANCISCO.

BOUTIQUES: PASPALEY SYDNEY, LV SINGAPORE (FURNISHING SUPPLY), LV VENEZIA, SWISS WATCHES LUXURY BRAND MILAN, YSL VENICE, YSL AMSTERDAM, YSL PARIS, YSL BRUXELLES, YSL BAHREIN, D&G DUBAI, D&G HOME TASHKENT, D&G HOME JEDDAH.





## BUDRI JOINS MESTIERI - SOMEK GROUP

IN JULY 2022, BUDRI HAS JOINED THE MESTIERI DIVISION OF SOMEK GROUP: A GREAT OPPORTUNITY OF GROWTH AND SYNERGY WITH A PRESTIGIOUS PARTNER IN THE REALIZATION OF HIGH-END PROJECTS.

SOMEK S.p.A. SPECIALISES IN THE ENGINEERING, DESIGN AND REALISATION OF COMPLEX TURNKEY CIVIL AND NAVAL ENGINEERING PROJECTS CONTRACT SEGMENTS: ENGINEERED SYSTEMS FOR NAVAL ARCHITECTURE AND CIVIL FACADES. PROJECTS MANAGED BY THE GROUP STAND OUT FOR THEIR HIGH LEVELS OF CUSTOMISATION AND MATERIAL-SPECIFIC KNOW-HOW, A FUNDAMENTAL REQUIREMENT IN PROJECTS WITH HIGH ADDED VALUE.

“BECOMING PART OF A PRESTIGIOUS GROUP AS SOMEK, ONE OF THE MAIN WORLD OPERATORS SPECIALIZED IN THE ENGINEERING, DESIGN AND IMPLEMENTATION OF COMPLEX TURNKEY PROJECTS IN THE CIVIL AND NAVAL DIVISION, MARKS THE BEGINNING OF AN IMPORTANT EVOLUTION FOR OUR COMPANY” STATES BUDRI’S CEO **GIAN MARCO BUDRI**. “BEING PART OF A GROUP OPENS NEW HORIZONS TO INCREASINGLY AMBITIOUS GOALS AND ENHANCE BUSINESS AND GROWTH CAPABILITIES IN THOSE HIGH-END MARKETS THAT CAN BE TACKLED WITH THE STRENGTH OF COLLABORATING COMPANIES”.

ITALIAN CRAFTSMANSHIP IS THE BEARER OF KNOWLEDGE APPLIED TO INNOVATIVE PROCESSES INVOLVING CUTTING-EDGE TECHNOLOGY, TO TAKE OLD EXPERTISE TO NEW LIMITS. MESTIERI IS A NETWORK OF TALENTED CREATORS OF EXCEPTIONALLY UNIQUE DESIGNS.

MESTIERI CREATES INTERIORS FOR RESIDENTIAL AND RETAIL SETTINGS, HOTELS, DINING ESTABLISHMENTS, YACHTS, AND CRUISE SHIPS. THEY COME TO LIFE THROUGH THE WORK OF THE CRAFTSMEN INVOLVED, WHILE MESTIERI ACTS AS A GUARANTOR OF THE RESULT, PROTECTING AND PROMOTING TIMELESS KNOW-HOW AND BRILLIANCE.

THROUGH CREATION, MESTIERI EXALTS THE COMPOSITE KNOW-HOW OF BRAIN AND MATTER, AT THE HEART OF ITALIAN EXCELLENCE. WITHIN THE GROUP, UNIQUE CRAFT SPECIALISTS FIND NEW STRENGTH, WHILST SAFEGUARDING SKILLS AT RISK OF BEING LOST.

“I HAVE ALWAYS FIRMLY BELIEVED IN VIRTUOUS SYNERGIES BETWEEN ITALIAN CRAFTSMANSHIP COMPANIES, BECAUSE THROUGH THE SIMULTANEOUS ACTIVITY OF DIFFERENT “ACTORS” BRINGS TO RESULTS THAT ARE REMARKABLY HIGHER THAN THE SUM OF INDIVIDUAL ACTIVITIES.

WORKING TOGETHER MEANS WINNING TOGETHER, GIVING CONTINUITY TO THE EXTRAORDINARY HERITAGE OF ITALIAN KNOW-HOW” CONCLUDES **GIAN MARCO BUDRI**.

**OSCAR MARCHETTO**, PRESIDENT OF SOMEK, POINTS OUT:

“WHEN I THOUGHT ABOUT CREATING MESTIERI, I WANTED TO CREATE A COMPANY CAPABLE OF ATTRACTING UNIQUE EXCELLENCE, RECOGNIZED THROUGHOUT THE WORLD FOR THEIR KNOW-HOW AND FOR THAT ALL-ITALIAN QUALITY THAT MAKES THE DIFFERENCE.

BUDRI, WHO JOINS OUR GROUP, EXACTLY REPRESENTS THE LEVEL OF ABILITY, EXPERIENCE, PROFESSIONALISM AND COMPETENCE THAT WE WANT TO BRING TO COMMON FACTOR. IT STANDS OUT FOR THE SKILL WITH WHICH IT MANAGES TO SHAPE THE HARDNESS OF MARBLE, GIVING LIGHTNESS AND VERSATILITY TO THIS MATERIAL, WORKING IT AS IF IT WERE A PRECIOUS FABRIC. I EXPRESS GREAT SATISFACTION WITH THIS OPERATION, AS IT ACCELERATES MESTIERI’S DEVELOPMENT PATH, ALLOWING US AN INCREASINGLY EFFECTIVE PENETRATION OF GLOBAL MARKETS IN THE HIGH-END INTERIORS SECTOR. THE OPERATION WILL CONTRIBUTE TO THE ENHANCEMENT OF ITALIAN HANDCRAFTED CREATIONS ON A PAR WITH WORKS OF ART, OF WHICH BUDRI REPRESENTS A HISTORIC CUSTODIAN”.

AS PART OF THE CORPORATE STRUCTURE, **GIAN MARCO BUDRI** REMAINS CEO OF THE BUDRI COMPANY AS IN LINE WITH THE COMPANY’S ENTREPRENEURIAL AND MANAGEMENT CONTINUITY STRATEGY, CONTINUING WITH HIS TEAM TO FOLLOW HIS CUSTOMERS WITH PASSION AND DEDICATION IN ITALY AND IN THE WORLD, AS IN THE LAST 42 YEARS OF ITS ACTIVITY.

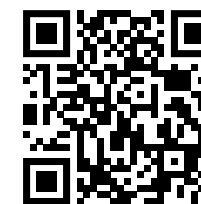

DISCOVER MESTIERI





THE LIGHTNESS OF WEIGHT:  
MARBLELACE SCREEN - DESIGN PATRICIA URQUIOLA  
BEST COMMUNICATOR AWARD 2010

## OUR BRAND IDENTITY

THE OXYMORON “THE LIGHTNESS OF WEIGHT”  
IS OUR RECURRENT THEME.

ENHANCING MARBLE – A SEEMINGLY RIGID, AUSTERE AND  
BARELY MALLEABLE MATERIAL – WITH A LIGHT, DYNAMIC  
EFFECT. WE TREAT IT LIKE A PRECIOUS FABRIC, ABANDONING  
ALL PRECONCEPTIONS AND RESERVATIONS TOWARDS IT.  
IT IS ONLY THROUGH THIS APPROACH THAT WE CAN BREAK  
BARRIERS AND ENTER THE SOUL OF THE MARBLE, FREEING THE  
WONDERS IT CONTAINS.

FOR US – PIONEERS IN ARTISTIC INLAYS, DESIGN AND MICRO-  
PROCESSES – MARBLE IS A WEAVE THAT WE “TAILORS” HAVE  
THE HONOUR OF WORKING WITH.

CONSCIOUS OF THE IMMENSE VALUE THAT NATURE LEAVES  
US AND ASKS US TO PRESERVE OVER TIME, WE HONOUR THIS  
MATERIAL, SHAPING IT AND TRANSFORMING IT WITH PASSION.  
NOBODY EVER REALLY OWNS A MARBLE INLAY: IT MUST BE  
CHERISHED FOR THOSE WHO WILL EXPERIENCE IT AFTER US.

OUR LOGO REPRESENTS A LONG JOURNEY, A STORY THAT  
BEGAN IN THE 1960s.

RESEARCH LED GWENAELE NICOLAS - CURIOSITY TOKYO  
TO DESIGN A LOGO THAT REPRESENTS THE PERFECT  
COMBINATION OF SOLIDS AND VOIDS, OF SINUOUS CURVES  
THAT INTERSECT WITH RIGID, VERY THIN THREADS, LIKE A  
CLASSIC INLAY WITH A VEILED ALLUSION TO THE FUTURE...  
THE FONT IS CONTEMPORARY, MORE AGGRESSIVE AND  
LINEAR BECAUSE IT REFLECTS NEW TRENDS IN ARCHITECTURE,  
FASHION AND DESIGN.

THE SMALL INLAY INSTEAD OF A DOT ON THE “I” IS A LINK  
WITH THE PAST, DELIBERATELY POSITIONED BEYOND THE  
CENTRE OF THE LAST LETTER. THINKING OUTSIDE THE BOX,  
WE SOMETIMES DARE TO ACHIEVE THE IMPOSSIBLE BECAUSE  
WE LOVE TO THRILL AND AMAZE.

IN PURSUIT OF NEW HORIZONS TO GIVE THIS NOBLE MATERIAL  
THE UNDISPUTED IMPORTANCE IT DESERVES.

 **BUDRI**

WHEN FUTURE  
GENERATIONS JUDGE THOSE  
THAT CAME BEFORE THEM  
ON ENVIRONMENTAL ISSUES,  
THEY COULD COME TO THE  
CONCLUSION THAT THEY  
“DIDN'T KNOW” LET'S MAKE  
SURE THAT WE DON'T GO  
DOWN IN HISTORY AS THE  
GENERATION THAT KNEW,  
BUT DID NOTHING.

*MICHAIL GORBAČEV*

“SUSTAINABILITY”, THEREFORE, IS NOT A WORD TO BE TAKEN LIGHTLY – EVEN MORE SO WHEN, LIKE US, YOU WORK WITH SUCH A PRECIOUS MATERIAL, ONE THAT HAS BEEN EVOLVING FOR MILLIONS OF YEARS AND BECOMES MORE VALUABLE EVERY DAY.

BUDRI S.R.L. HAS ALWAYS BEEN COMMITTED TO PROTECTING THE ENVIRONMENT AND OUR NATURAL RESOURCES.

SUSTAINABILITY IN AN ABSOLUTE SENSE DOES NOT EXIST. YET, A THOROUGH PROCESS COMBINING RESEARCH AND AWARENESS GRADUALLY LEADS TO A MORE SUSTAINABLE APPROACH.

BUDRI'S SLIM MARBLE PROJECT WAS AWARDED BY THE EUROPEAN UNION'S FRAMEWORK PROGRAMME FOR RESEARCH AND INNOVATION, HORIZON 2020, WHICH AIMS TO DELIVER INNOVATION. FOR YEARS, OUR RESEARCH & DEVELOPMENT DIVISION HAS BEEN LOOKING AT TECHNOLOGIES, TECHNIQUES AND INNOVATIVE COMPOSITES THAT SAFEGUARD THE VALUE OF THE MATERIAL.

REDUCING THE MARBLE'S WEIGHT TO FACILITATE WORKING ON SMALLER THICKNESSES MEANS A REDUCED IMPACT ON EXCAVATION, THE ECOSYSTEM AND ITS GEOMORPHOLOGICAL STRUCTURE.

EQUALLY IMPORTANT IS THE REDUCTION IN POLLUTION FROM THE TRANSPORT OF THE MATERIAL.

DURING THE PRODUCTION PHASE, WE DISPOSE OF WOOD, PLASTIC, STONE OFFCUTS, METALS AND MACHINING SLUDGE IN ACCORDANCE WITH CURRENT GUIDELINES AND THROUGH CAREFULLY-CHOSEN AUTHORISED CHANNELS.

OTHER STRATEGIC MEASURES WE HAVE TAKEN IN REGARD TO ENVIRONMENTAL SUSTAINABILITY INCLUDE WORKING TOWARDS OBTAINING RELEVANT CERTIFICATION, SUCH AS ISO 14001 AND SA8000, WHICH THE COMPANY IS WORKING TOWARDS.

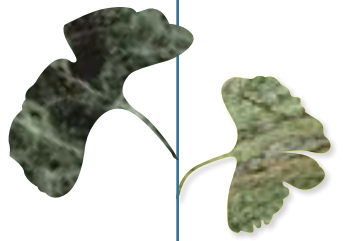





# BUDRI MILANO

## AN HAUTE COUTURE ATELIER IN THE HEART OF THE CITY

“BUDRI MILANO IS NOT A FINISH LINE BUT A STARTING POINT. AFTER SIXTY YEARS IN BUSINESS, WE HAVE CHOSEN THIS INTERNATIONAL CITY OF ART, HISTORY, CULTURE, DESIGN AND FASHION TO PRESENT OUR WORLD OF MARBLE; A SPACE THAT TELLS THE STORY OF ARCHITECTURE’S MOST NOBLE MATERIAL, A PLACE THAT WILL BECOME A CREATIVE HUB FOR DESIGNERS AND ARCHITECTS, A MAGICAL WORLD FOR THOSE WISHING TO EXPLORE THE UNIQUE BEAUTY OF NATURE. **THE NEW SHOWROOM** INAUGURATED IN 2019 IS METICULOUSLY STUDIED IN EVERY DETAIL TO GIVE VOICE TO MARBLE AND SEMI-PRECIOUS STONES.

LOCATED RIGHT IN THE HEART OF MILAN, AT FORO BUONAPARTE, BUDRI MILANO IS A TANGIBLE EXPRESSION OF THE COMPANY’S CONSTANT EVOLUTION, OF ITS FOCUS ON A FUTURE OF GROWTH, RESEARCH AND EXPERIMENTATION, WHERE BEAUTY INFORMS EVERY BUSINESS CHOICE. HENCE THE CHOICE OF SUCH A PRESTIGIOUS LOCATION, STEEPED IN HISTORY, ART AND CULTURE TO IMMERSE THE VISITOR IN AN EXCLUSIVE EXPERIENCE AND CONVEY THE COMPANY’S VOCATION FOR UNIQUENESS.

THE NEW DISPLAY SPACE IS NOT SIMPLY A SHOWROOM, BUT IS INTENDED AS A DYNAMIC MEETING PLACE FOR ARCHITECTS, DESIGNERS AND CONNOISSEURS OF DESIGN, WHERE CREATIVE IDEAS TAKE SHAPE: ELEGANT SOLUTIONS, CHROMATIC AND MATERIAL JUXTAPOSITIONS SUITED TO ALL TYPES OF CONTRACT, RESIDENTIAL AND RETAIL PROJECTS.

THE CONCEPT FOR THE SHOWROOM WAS SPARKED BY THE DESIRE TO “GIVE VOICE TO MARBLE”, IN OTHER WORDS TO TELL ABOUT A PROCESS THAT STARTS FROM THE RAW MATERIAL AND TRANSFORMS IT INTO DIFFERENT LANGUAGES. MARBLE IS AN APPARENTLY RIGID AND AUSTERE MATERIAL THAT, IN FACT, TURNS OUT TO BE EXTREMELY EXPRESSIVE. IT IS UP TO THOSE OF US WHO WORK IT TO UNDERSTAND IT AND LET IT EXPRESS ITSELF”, CLAIMS **ALESSANDRA MALAGOLI** BUDRI, THE COMPANY’S ART DIRECTOR.







THE 350 M SPACE IS SPREAD OVER THREE FLOORS WITH A SPECIFIC DISPLAY ARRANGEMENT: THE GROUND FLOOR HOSTS THE DESIGN COLLECTIONS, NAMELY SURFACES AND FURNISHING ACCESSORIES. IN ADDITION, AN ELEGANT LOUNGE AREA LOOKS ONTO THE PALAZZO'S LIBERTY STYLE COURTYARD.

THE BASEMENT FLOOR IS DEDICATED TO CLASSIC SURFACES AND THE "MARBLE LIBRARY", A MAGICAL WORLD SHOWCASING MARBLE AND ONYX. THE MEZZANINE FLOOR MEANWHILE IS RESERVED FOR BUSINESS MEETINGS.

















## \_SERVICES AND CONSULTATION WORLDWIDE

- 01 QUARRYING OF THE MARBLE  
SELECTION OF THE BLOCK AT THE QUARRY WITH OUR SPECIALIZED BLOCK TESTER
- 02 SELECTION OF THE MATERIAL ACCORDING TO SPECIFIC QUALITY CHARACTERISTICS
- 03 VISUAL INSPECTION DURING ACCEPTANCE OF THE MATERIAL TO VERIFY QUALITY DEGREE
- 04 SLAB ANALYSIS OF EACH SLAB AND SELECTION OF ONLY EXTRA QUALITY PARTS
- 05 SITE SURVEYS WITH BUDRI TECHNICAL EXPERTS WORLDWIDE
- 06 PRODUCTION OF SHOP DRAWINGS
- 07 THE ENTIRE PRODUCTION PROCESS IS STRICTLY CARRIED OUT IN ITALY, AT OUR MIRANDOLA PLANT
- 08 APPROVAL BY ARCHITECT OR CLIENT ON THE BASIS OF PRE-ASSEMBLY AT OUR PLANT
- 09 PACKAGING FOR EXPORT IN CLOSED WOODEN CRATES WITH ANTI-TIPPING BARS
- 10 FREIGHT AND ASSISTANCE WITH PAPERWORK
- 11 INSTALLATION AND POLISHING WORLDWIDE BY BUDRI'S HIGHLY SKILLED TEAMS AND PROJECT MANAGERS
- 12 FINAL TESTING OF THE INSTALLATION SUPERVISED BY THE DIRECTOR OF WORKS

## SERVING ARCHITECTS

BUDRI ENSURES ARCHITECTS AND DESIGNERS ALL THE EXPERTISE AND SKILLS NEEDED TO EXECUTE THEIR PLANS.

ARCHITECTS AND DESIGNERS BENEFIT FROM DEDICATED SUPPORT SERVICES, FROM IN-HOUSE DESIGN CONSULTATION TO TECHNICAL CONSULTATION REGARDING THE CHOICE OF MATERIALS AND SURFACE TREATMENTS; IT IS A PARTNERSHIP THAT THRIVES ON CONSTANT EXCHANGE OF SKILLS AND SHARING OF AIMS. THE RELATIONSHIP THAT BUDRI MAINTAINS WITH ARCHITECTS AND DESIGNERS HAS EARNED THE COMPANY ACCOLADES.

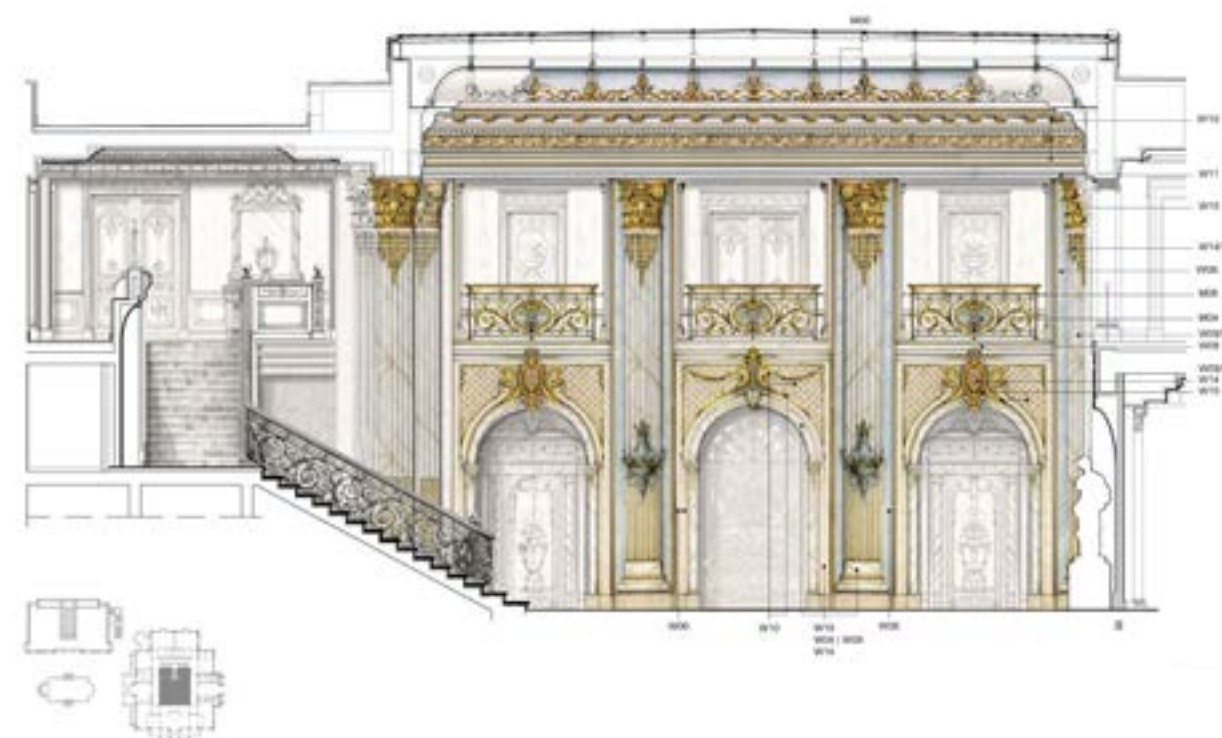



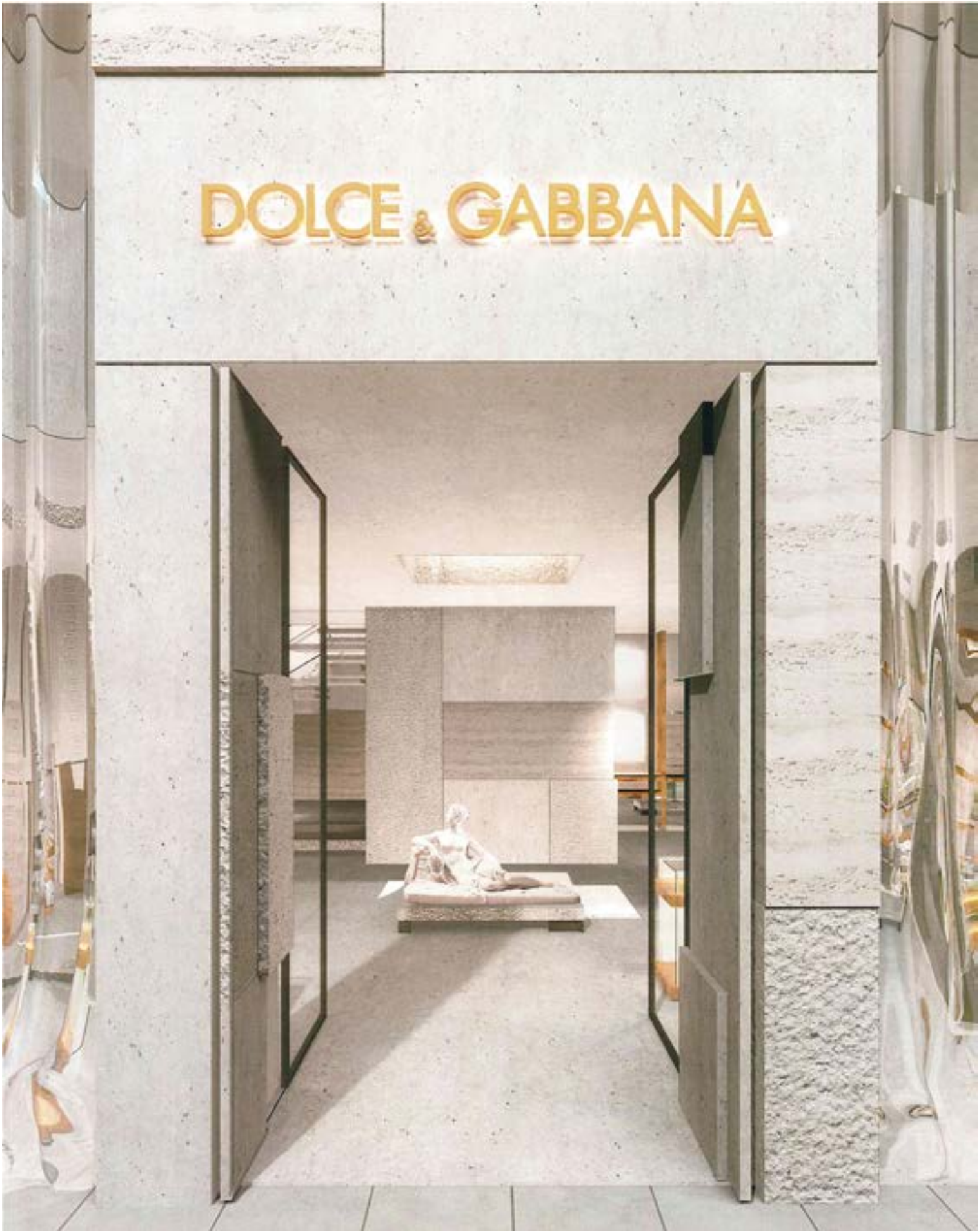

PROJECT BY CURIOSITY JAPAN - DESIGN GWENAELE NICOLAS



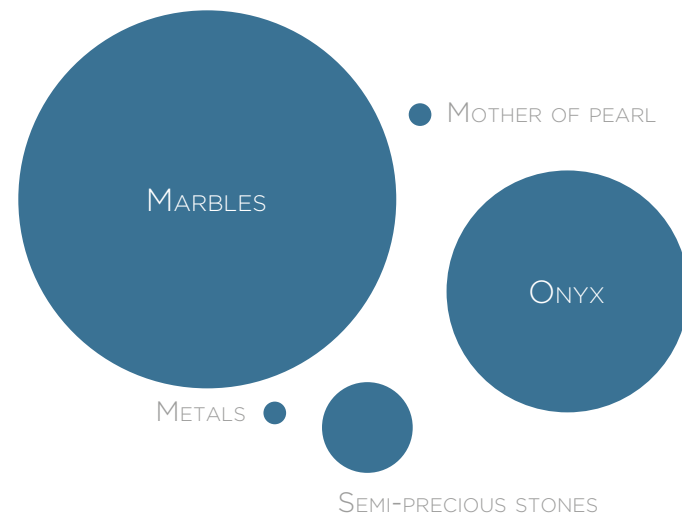

MOTHER OF PEARL \_\_\_ 3%  
 MARBLES \_\_\_\_\_ 50%  
 METALS \_\_\_\_\_ 3%  
 ONYX \_\_\_\_\_ 32%  
 SEMI-PRECIOUS  
 STONES \_\_\_\_\_ 12%

\* AGGREGATE DATA BASED ON  
 TYPE OF MATERIAL

## BECAUSE NATURE IS TRULY EXTRAORDINARY

BUDRI SELECTS THE  
 FINEST MARBLES  
 FROM ALL OVER THE  
 WORLD.

THE PAINSTAKING SELECTION  
 OF SLABS OF MARBLE, ONYX  
 AND SEMI-PRECIOUS STONE  
 OF OUTSTANDING QUALITY  
 ENDOWS BUDRI PROJECTS  
 WITH SUBLIME AESTHETIC AND  
 INTERPRETATIVE QUALITIES.  
 WE HANDLE EVERY SLAB  
 THAT WE WORK WITH THE  
 GREATEST OF RESPECT  
 AND PASSION, HONOURING  
 THE INTRINSIC VALUE IT  
 NATURALLY POSSESSES.





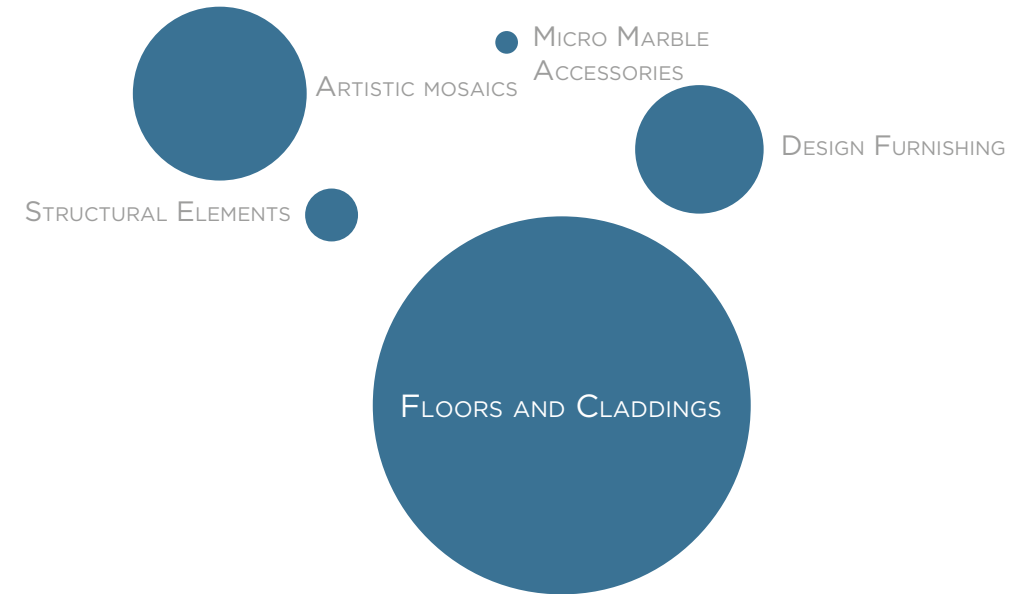

FLOORS  
AND CLADDINGS \_ 50%  
ARTISTIC MOSAIC \_ 23%  
DESIGN FURNISHING 17%  
STRUCTURAL  
ELEMENTS \_\_\_\_\_ 7%  
MICRO MARBLE  
ACCESSORIES \_\_\_\_\_ 3%

\* DATA % BASED ON TYPE OF  
STYLES AND FUNCTIONS

# MARBLE: THE UNDISPUTED STAR

MARBLE PLAYS THE LEADING  
ROLE IN BUDRI'S PROJECTS,  
AS THE REAL "STAR" ON THE SET.

BUDRI IS THE IDEAL PARTNER FOR  
INTERIOR AND EXTERIOR DESIGN  
PROJECTS, IN THE CONTRACT RESIDENTIAL  
AND RETAIL DIVISIONS. CUTTING-EDGE  
TECHNOLOGIES AND KNOW-HOW ALLOW  
US TO PRODUCE STRUCTURAL ELEMENTS  
OF GREAT IMPACT SUCH AS COLUMNS,  
GATEWAYS, FOUNTAINS, BALUSTRADES  
AND CAPITALS.

INLAY, ARTISTIC MOSAIC AND BOOK-  
MATCHED WALL AND FLOOR COVERINGS  
FOR INTERIORS AND EXTERIORS ARE THE  
JEWEL IN THE COMPANY'S CROWN.





ARTISTIC MOSAIC - SWIMMING POOL FLOOR IN POLYCHROME MARBLES, 10 x 7 METERS.







## TIMELESS EXCELLENCE

BUDRI CREATIONS INCREASE  
IN VALUE OVER TIME

DESIGNED AND PRODUCED EXCLUSIVELY IN ITALY, BUDRI CREATIONS HAVE A HIGH INTRINSIC VALUE DESTINED UNEQUIVOCALLY TO PRODUCE A RETURN ON THE INITIAL INVESTMENT. WITH ITS EVERY CREATION, BUDRI AIMS TO STIR EMOTIONS, COMBINING THE NATURAL VALUE OF THE MATERIAL WITH AN EXPERT EYE FOR DETAIL.

THE CONSCIOUS DECISION TO PRODUCE EXCLUSIVELY IN-HOUSE IN ITALY ALLOWS BUDRI TO FULLY MONITOR AND CONTROL PROJECTS AT EVERY STEP, FROM SAMPLING TO DESIGN AND THE FINAL INSTALLATION PROCESS.





THE ITALIAN MANUFACTURING CULTURE EMBODIES THE ABILITY TO FACE CHALLENGES WITH CREATIVITY AND A SARTORIAL APPROACH.

BUDRI'S EXPERTISE EMERGED AND EVOLVED WITHIN THE CONTEXT OF THE ITALIAN CRAFTSMANSHIP TRADITION, DRIVEN BY AN ONGOING PROCESS OF RENEWAL AND GROWTH. THE INTERACTION BETWEEN ANCIENT WISDOM AND HAND-CRAFTING EXPERTISE GIVES BIRTH TO UNPARALLELED CREATIONS: WITH OUR HANDS WE BRING TO LIFE WHAT WAS ONCE ONLY A PRODUCT OF THE MIND.



BESPOKE PROJECT FOR Paspaley, world reknown pearl brand.  
WHITE ONYX WALL CLADDING FOR THE INTERIORS ENGRAVED WITH 24 K GOLD LEAF.  
> SEE BOUTIQUE PAGE 92.







HAND-CRAFTED ARTISTIC MOSAIC ACCORDING TO THE TRADITIONAL MOSAIC ART SCHOOL OF RAVENNA:  
CUTTING OF THE TESSERAE BY HAND WITH THE AID OF A HARDIE AND A HAMMER.



HAND-CRAFTED MARBLE INLAY, ACCORDING TO AN ANCIENT ITALIAN TRADITION STARTED  
WITH THE ROMAN EMPIRE. THIS HERITAGE CONTINUES IN BUDRI, THANKS TO THE EXPERT  
HANDS OF THOSE WHO KNOW HOW TO BRING OUT BEAUTY.



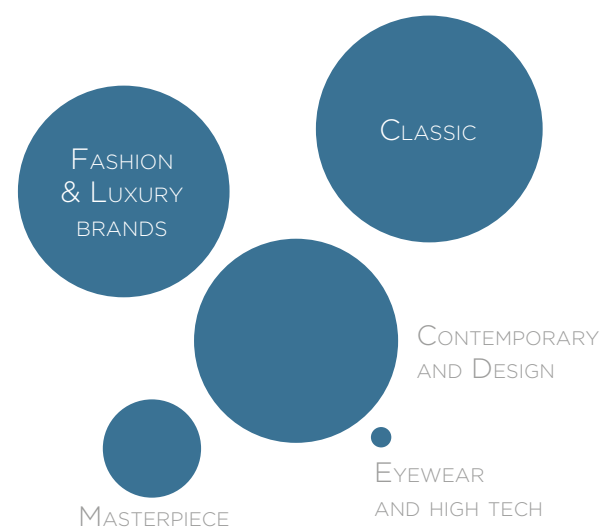

CLASSIC \_\_\_\_\_ 30%  
 FASHION & LUXURY BRANDS \_\_\_\_\_ 28%  
 CONTEMPORARY AND DESIGN \_\_\_\_\_ 27%  
 MASTERPIECE \_\_\_\_\_ 13%  
 EYEWEAR AND HIGH TECH \_\_\_\_\_ 2%

\* DATA % BASED ON TYPE OF STYLES AND PRODUCTS

## TRADITION AND INNOVATION

WITH ITS CREATIVE, TECHNOLOGICALLY ADVANCED APPROACH, BUDRI RESPONDS TO THE CONSTANT STREAM OF STIMULI FROM THE CREATIVE WORLD.

THE “LUCIPETUS” WALL PATTERN IN BIANCO STATUARIO MARBLE DESIGNED BY LUCA SCACCHETTI, IS AN EXTRAORDINARY EXAMPLE OF 3D EFFECT WORKMANSHIP.

A SUCCESSION OF GEOMETRIC SHAPES OF DIFFERENT THICKNESSES CREATES A CONTEMPORARY INTERPRETATION OF A ‘DAMASK FABRIC’. THE LAVISH PATTERN GRADUALLY MELTS AWAY, LEAVING ISOLATED TRACES ON THE ELEGANT WALL COVERING IN SOLID WHITE STATUARIO.









BEAUTY  
WILL  
SAVE  
THE  
WORLD

*F.DOSTOEVSKIJ*



GIANMARCO BUDRI

OUR PASSION STEMS FROM REVERENCE FOR THE RARE, PRECIOUS MATERIAL THAT WE ARE PRIVILEGED TO WORK, FROM AWARENESS OF THE INTRINSIC VALUE THAT OUR CREATIONS MUST HAVE, THE VALUE OF UNIQUENESS.

OUR AIM IS TO RENDER BUDRI PROJECTS UNIVERSALLY RECOGNISABLE FOR THEIR QUALITY, REFINEMENT AND THE PASSION THEY REFLECT. I EMBRACE THE RESPONSIBILITY TO HONOUR ITALY'S GREAT ARTISTIC PAST AND TO EMBUE MATERIALS WITH OUR LOVE OF SUCH MAGNIFICENCE.

WE ARE INEXTRICABLY LINKED TO A WORLD THAT TURNS ON VALUES AND EMOTIONS. FOR US, BEAUTY IS THE DRIVER OF ALL OUR BUSINESS DECISIONS. WE HAVE AN AMBITIOUS VISION, FOCUSED ON ACHIEVING A STREAM OF NEW GOALS, WHICH DRIVES US TO EMBRACE CHALLENGES IN WHICH THE MATERIAL IS DESIGNED AND WORKED TO PLAY THE STARRING ROLE.

OUR PHILOSOPHY IS ALWAYS GEARED TOWARDS OPTIMISATION OF WORKING PROCESSES AND IMPROVEMENT, SEEKING THE PERFECT SYNERGY BETWEEN TECHNOLOGICAL INNOVATION AND HUMAN TALENT.

THE COMMON DENOMINATOR LINKING ALL OUR RESOURCES IS OUR EXPERIENCE AND LOVE FOR OUR WORK.

THE ABILITY TO CAPTURE THE ESSENCE OF A PROJECT AND SHARE THE THRILL OF SEEING IT COME TO FRUITION.



\_MANAGEMENT AND  
FINANCE

MANAGEMENT  
HUMAN RESOURCES  
BANKS  
FINANCE AND CONTROL  
SAFETY

\_SALES

MARKETING  
SALES AGENTS  
QUOTATIONS  
PROJECT CONSULTANTS  
SITE INSPECTIONS

\_OPERATIONS

PROJECT MANAGEMENT  
STRUCTURAL ENGINEERING  
PRODUCTION MANAGEMENT  
PURCHASING  
SAMPLING  
WAREHOUSE  
LOGISTICS  
RESEARCH &  
DEVELOPMENT

\_PRODUCTION AND  
SERVICES

CUTTING  
ASSEMBLY  
FINISHING  
DRY LAYING  
MOSAICS  
RESTORATION  
TREATMENT  
POLISHING

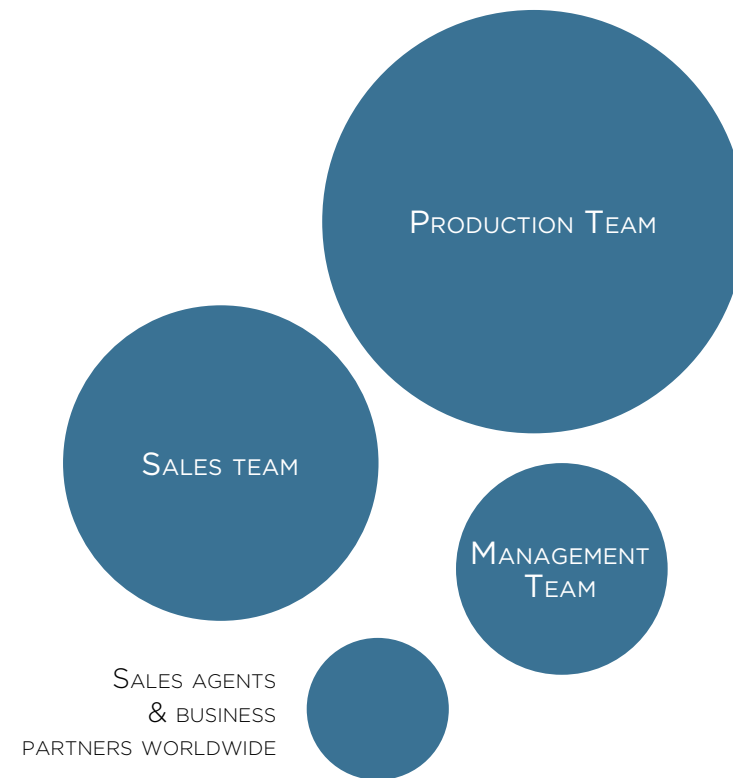

TEAMWORK

HUMAN RESOURCES  
ARE BUDRI'S GREATEST ASSET.



PART OF BUDRI'S HEADQUARTERS TEAM

THE 95-STRONG TEAM OF COLLABORATORS, ARCHITECTS AND DESIGNERS ARE THE COMPANY'S TRUE LIFEBLOOD. SELECTED FOR THEIR TALENT, THEIR PROFESSIONAL ETHICS, THEIR PROACTIVE APPROACH TO WORK, AND ABOVE ALL FOR THE PASSION AND QUALITY THAT THEY CONVEY IN THEIR ACTIONS. THEY WORK AS A CLOSE-KNIT GROUP, MAKING BUDRI A WINNING TEAM.



ALL SURFACES OF OUR PROJECTS ARE DRY-LAYED FOR FINAL TESTING AND APPROVAL BY THE COMMITMENT.

FOR LARGE AND COMPLEX FLOORS OR CLADDINGS, BUDRI CAN PROVIDE THANK TO DRONE TECHNOLOGY, FOR A STILL ZENITH IMAGE OR VIDEO OF THE FINAL TESTING STAGE (DRY LAY-OUT) INSIDE BUDRI'S FACTORY.

INDEED THE NEWLY ACQUIRED DRONE SUPPLIES A PERFECT PERSPECTIVE OF THE ENTIRE WORK IN REAL TIME, ENABLING PERFECT FINAL TESTING OF THE OVERALL APPEARANCE.

DRONE TECHNOLOGY  
AIR VIEW IMAGES AND INTERACTIVE  
CONNECTION.







LEFT: DRY-LAYOUT OF CHAMPAGNE ONYX FLOOR WITH BRASS INLAIS, 22 x 11 MT.  
TOP: DRY-LAYOUT OF COMPLEX CIRCULAR INLAID FLOOR, 4-METERS DIAMETER, MADE OF 16.000 TINY INLAIS.



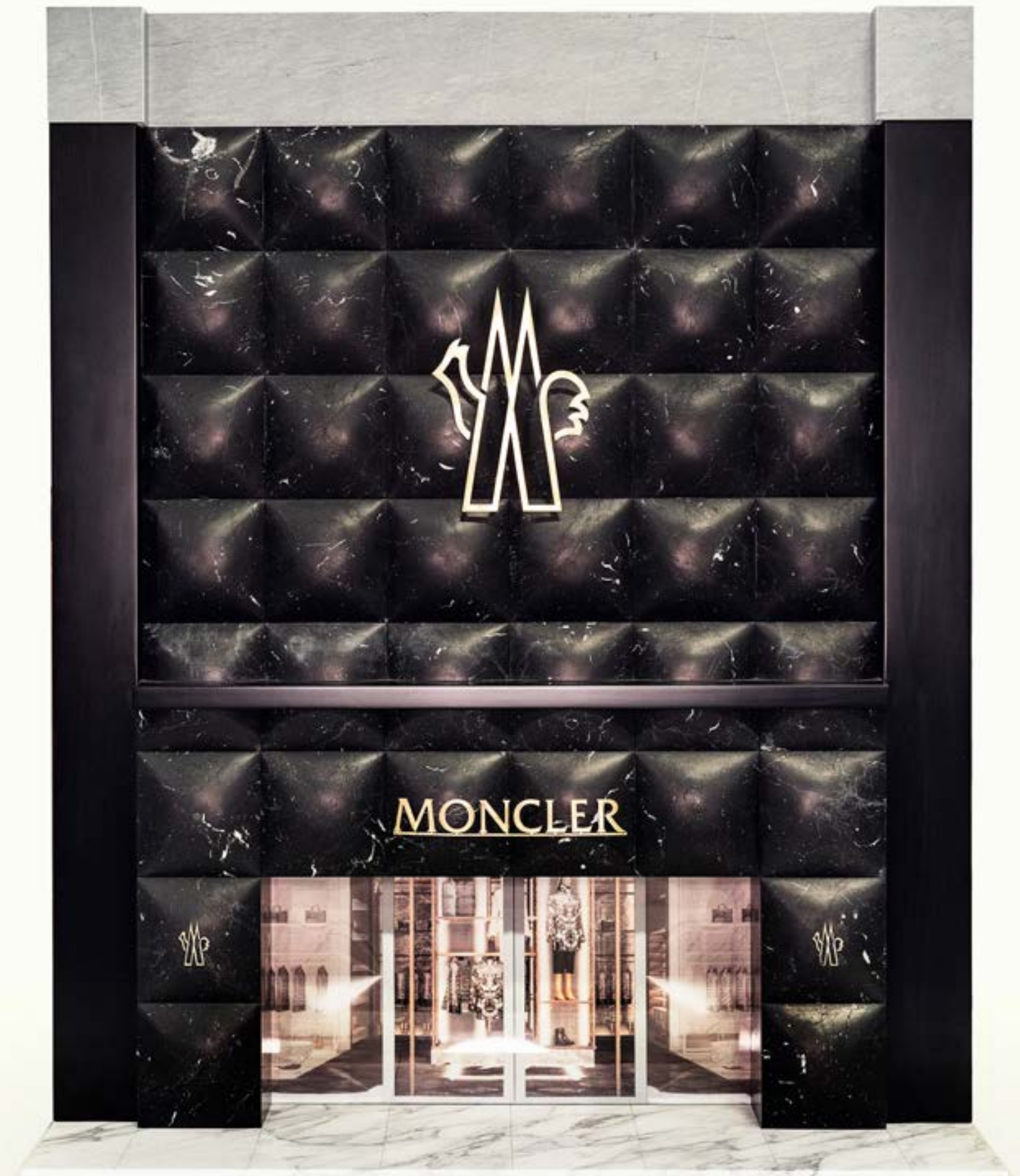

## Mockups

MOCKUPS ARE A FUNDAMENTAL PART OF BUDRI'S DESIGN STAGE.

WE PRODUCE TO-SCALE MOCKUPS, USING THE MATERIALS SELECTED BY THE CUSTOMER TO PRODUCE FACADES, COVERINGS OR FLAT SURFACES, ALLOWING THE DESIGNER TO ASSESS THE PROPORTIONS, THE ACTUAL EFFECT OF THE STONES AND THE OVERALL APPEARANCE OF THE WORK.

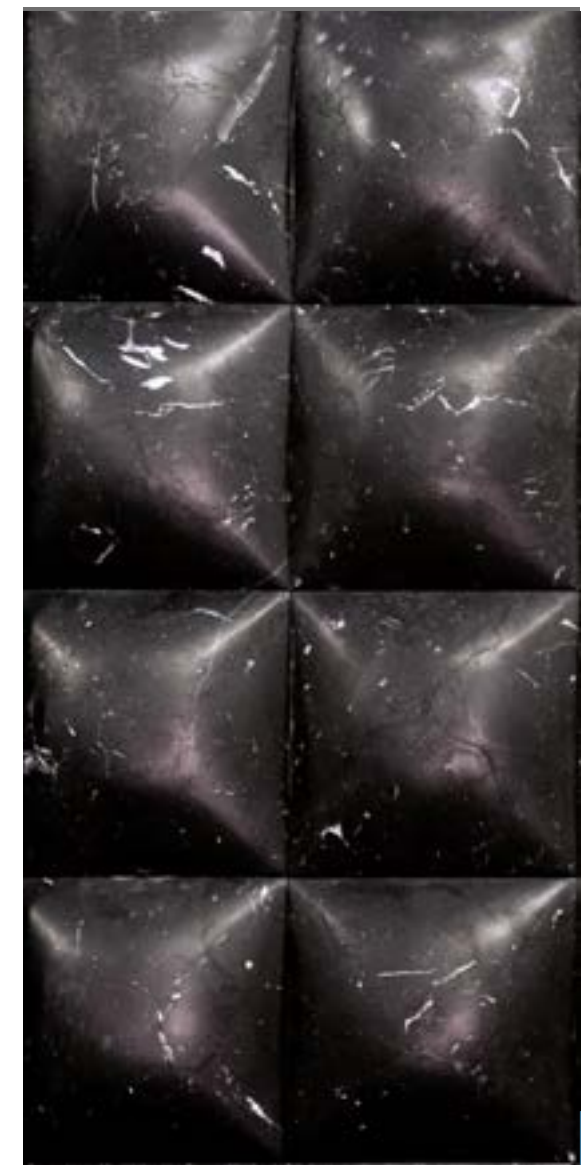

IN THIS PARTICULAR CASE, THE MOCK-UP REPRESENTS THE FACADE MADE OF NERO MARQUINIA MARBLE WITH A "DOWN" EFFECT AND THE CALACATTA FOX MARBLE ENTRANCE FLOOR.

SIZE 130x100 CM



MAIN HOTEL PROJECTS

- FOUR SEASONS HOTEL - MILAN
- WYNN HOTEL - LAS VEGAS
- PALAZZO AVINO - RAVELLO
- HOTEL ATLANTIS - ZURICH
- MOLINO STUCKY - VENICE
- HOTEL CORINTHIA - BUDAPEST
- BRIIG - SPLIT
- MARIENTURUM - FRANKFURT



PALAZZO AVINO, RAVELLO



ATLANTIS HOTEL, ZURICH













INFINITY WALL & FLOOR INLAY AND DISPLAY CASES FOR HOTEL LOBBY JEWELRY.  
DESIGN CURIOSITY STUDIO, TOKYO.





BUDRI IS PROUD TO HAVE BEEN INVOLVED IN THE MAKING OF THE CHEON WON PALACE, A 25.000 SQM TEMPLE AND SPIRITUAL CENTER IN THE HEART OF SOUTH KOREA. THE COMPANY HAS PRODUCED IN ONE-YEAR-TIME MANY PRESTIGIOUS FLOORS, STAIRS AND COLUMNS FOR A TOTAL SURFACE OF 5.500 SQUARE METERS. CHEON WON PALACE WAS COMPLETED AND OPENED TO PUBLIC IN 2023.

THE PROJECT, ENTIRELY CARRIED OUT AT BUDRI PLANT IN ITALY, WAS POSSIBLE DUE TO THE LONG-LASTING EXPERIENCE OF THE COMPANY IN SKILLFUL AND DEMANDING PROJECTS OF PUBLIC AND PRIVATE SPACES.



“MERIT AWARD - BUDRI SRL  
CEO GIANMARCO BUDRI”

*“We present this plaque with gratitude as your company has made a significant contribution to the completion of the ‘Cheonwon Palace’ despite the difficult conditions with passion and dedication. We hope for your development and achievement by continuing strong relationship with trust and faith between both companies in the future.”*

IL SHIN STONE CO., LTD.  
PRESIDENT HAK SUN KIM

BUDRI, AS THE CEO GIANMARCO BUDRI, HAS BEEN AWARDED WITH THE **MERIT AWARD** BY THE MAIN CONTRACTOR IL SHIN STONE CO. LTD. AS PRESIDENT HAK-SUN KIM, FOR THE SIGNIFICANT CONTRIBUTION TO THE COMPLETION OF THE CHEON WON PALACE IN SEOUL.

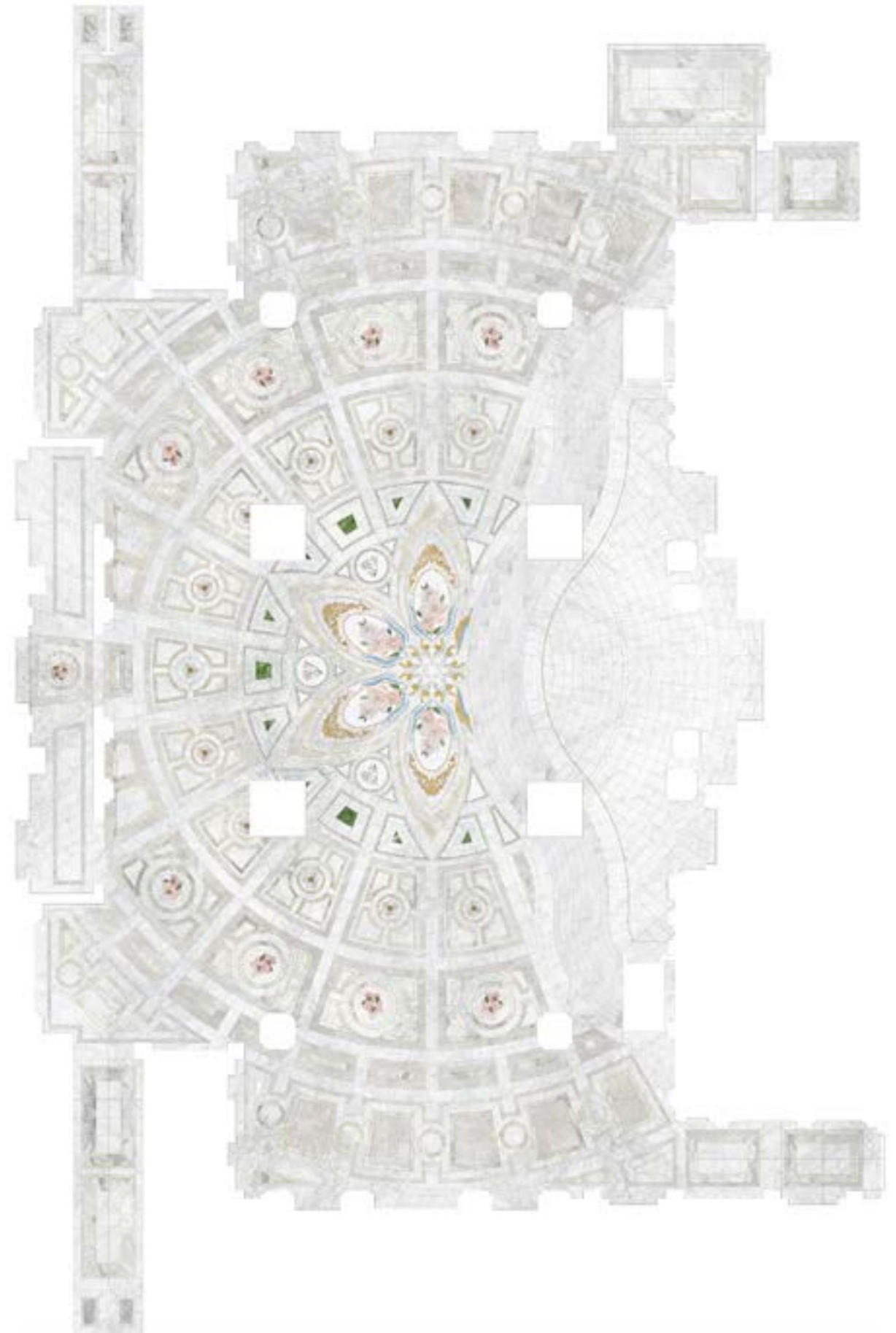

FLOOR PLAN FOR THE LOBBY HALL: 2000 SQM OF MARBLE INLAYS.  
© IL SHIN STONES, BUDRI, 2023



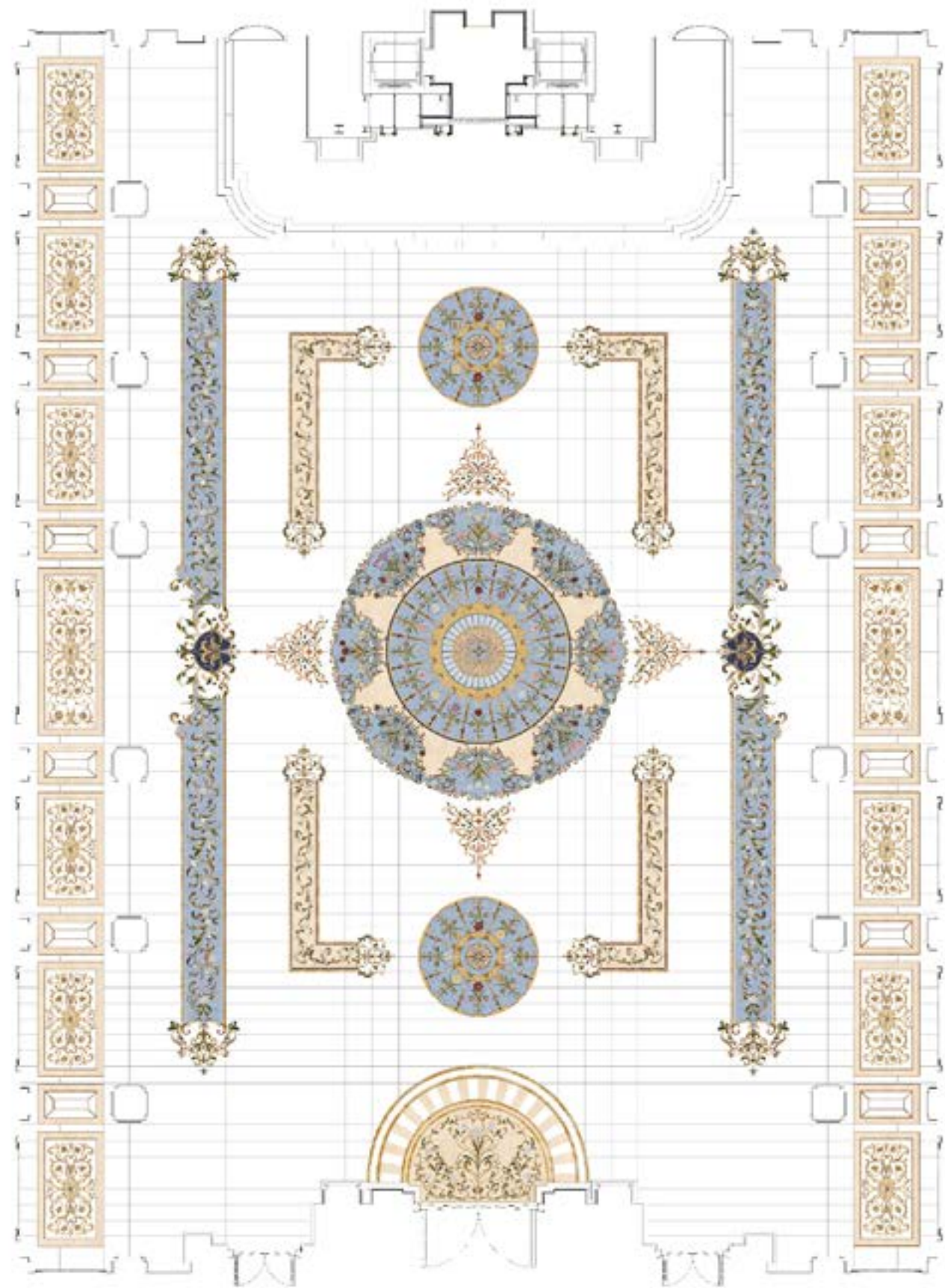

FLOOR PLAN FOR THE MEMORIAL HALL: 2100 SQM OF MARBLE INLAYS.  
© IL SHIN STONES, BUDRI, 2023







THE OUTSTANDING FLOOR INLAYS COVERING THE PRESTIGIOUS MAIN HALL ARE COMPOSED OF CIRCULAR FLOOR PATTERNS REPRESENTING FLOWER BOUQUETS, MADE OF THOUSANDS OF EXTRAORDINARY TINY INLAYS REPRESENTING IN DETAIL THE SHAPE AND COLOR SHADES OF EACH PETAL AND LEAF.









THE PERIMETER OF THE MAIN HALL CONSISTS OF 14 INLAID FLOOR CARPETS IN WHITE AND YELLOW STONES, WITH FLOREAL AND ELEGANT CLASSIC RAMAGE MOTIFS.



THE LOBBY HALL IS MADE UP OF INLAID FLOORS THAT DEVELOP IN A RADIAL PATTERN STARTING FROM A SUMPTUOUS FLORAL INLAY, THE FULCRUM OF THE COMPOSITION.











AFTER THREE YEARS OF CEASELESS WORK, THE YEAR 2007 SAW THE OPENING OF THE SHEIKH ZAYED ABU DHABI MOSQUE, THE SECOND LARGEST IN THE WORLD AFTER THE MEDINA MOSQUE.

THIS PROJECT WAS THE PERFECT SHOWCASE FOR THE ULTIMATE ITALIAN CREATIVITY AND FLAIR.

THE AMAZING FLORAL PATTERNS CONSISTING OF POLYCHROME MARBLE INLAIS THAT COVER MOST OF THE OUTER AND INNER SURFACES OF THE BUILDING. THE ELEGANT COMBINATION OF INLAY WORK AND MOSAICS HAS COVERED THE FAMOUS PLACE OF WORSHIP WITH AN ALL-NEW ELEGANT AND CONTEMPORARY LOOK.

THE INTERIORS WITH FLORAL INLAY WORK IN BIANCO LASA MARBLE, PRODUCED BY BUDRI, COVER FIVE WALLS, EACH MEASURING 1200 SQUARE METRES AND A HEIGHT OF 25 M. THE ALTERNATED POLISHED, BUSHHAMMERED AND SANDBLASTED SURFACE RESULTS IN A THREE DIMENSIONAL EFFECT TO THE GIANT DAISIES AND AN APPEALING LUSTRE TO THE INLAY WORK

THE INLAID WHITE DAISIES ARE ALTERNATED WITH BRIGHTLY-COLOURED MOSAIC DAISIES PRODUCED BY FANTINI MOSAICI, MILANO.

BUDRI ALSO PRODUCED 3600 SQUARE METRES OF INTERIOR INLAID WALLS IN POLYCHROME MARBLE WITH A “MARMORINO” PLASTER FINISH. THE PARTICULARLY GLOSSY EFFECT IS ACHIEVED THROUGH THE CONTRAST BETWEEN MATT AND SHINY SURFACES.





THE OUTDOOR SQUARE WAS ENTIRELY PAVED BY BUDRI WITH A GIANT INLAID FLORAL BOUQUET OF 17640 M<sup>2</sup>; FOUR THOUSAND INLAID AND MOSAIC PANELS (2,10 M X 2,10 M EACH) COVER INDEED THE ENTIRE AREA, FAMOUS FOR BEING THE LARGEST FLORAL INLAY WORLDWIDE.

FANTINI MOSAICI, MILANO: MAIN CONTRACTOR

BUDRI INTARSIO ITALIANO: SUBCONTRACTOR

PROJECT: SPATIUM STUDIO ASSOCIATO DI ARCHITETTURA, MILANO

INLAYS BY: BUDRI ITALIAN INLAY





## FASHION RETAIL DIVISION



THE COMPANY EXPRESSES ITS CREATIVITY IN THE FASHION RETAIL DIVISION CREATING MARBLE DETAILS THAT BECOME AN INTEGRAL PART OF BOTH JEWELRY AND LUXURY ACCESSORIES. MOREOVER BUDRI COLLABORATES WITH FASHION BRANDS FOR THE CREATION OF COMPLEX, BESPOKE FASHION BOUTIQUES, WORLDWIDE.

BUDRI COLLABORATES WITH FASHION AND JEWELRY BRANDS, IN A CONSOLIDATED RELATIONSHIP.





DOLCE & GABBANA BOUTIQUE - MIAMI











PASPALLEY BOUTIQUE, SYDNEY - DISPLAY IN WHITE IRANIAN ONYX WITH 24K GOLDEN LEAF FINISHING.

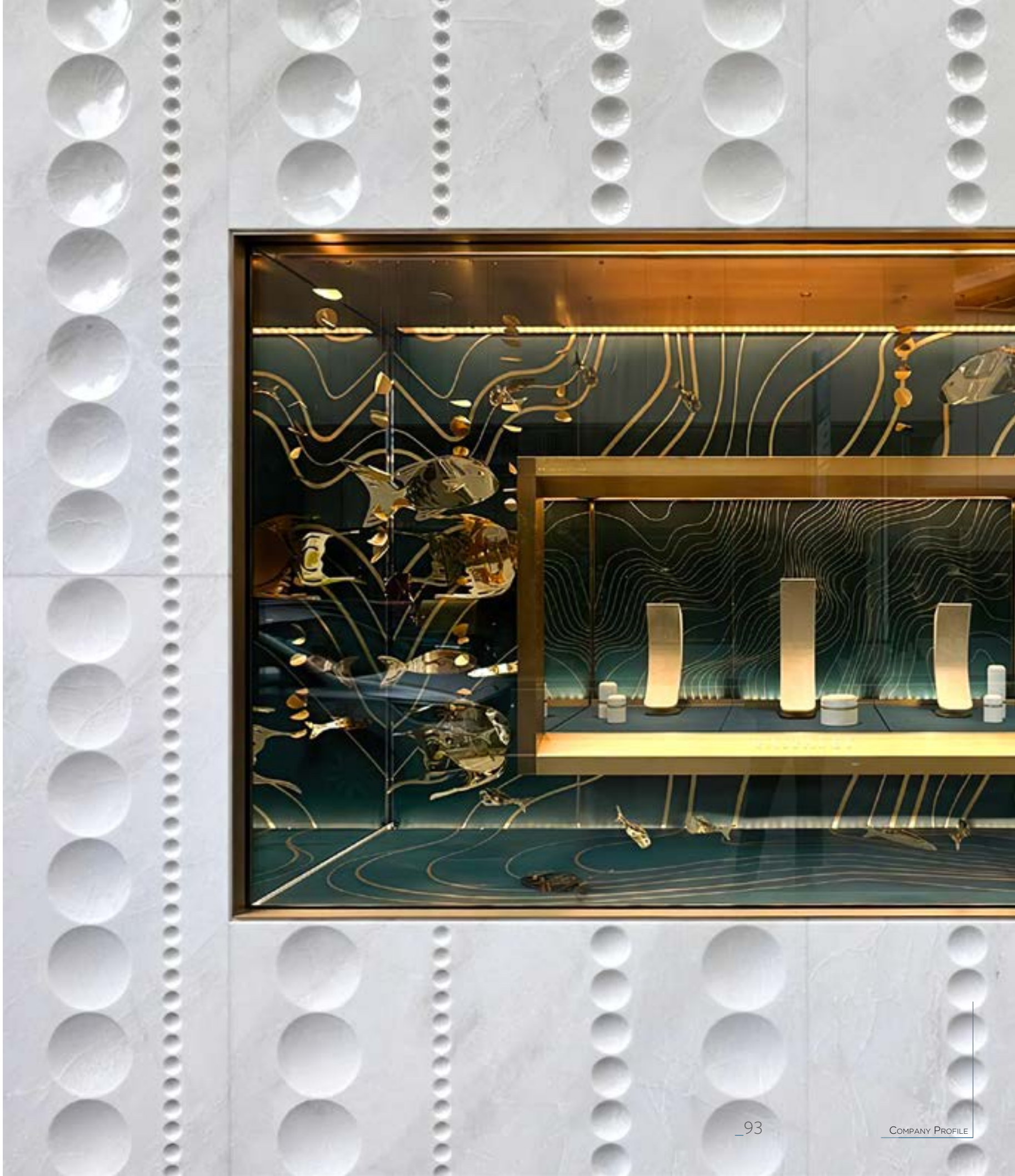





DOLCE & GABBANA

















FLOORING IN NERO MARQUIÑA - DOLCE & GABBANA JEWELRY BOUTIQUE  
VIA DELLA SPIGA, MILANO







DOLCE & GABBANA BOUTIQUE  
VIA DELLA SPIGA - MILAN





DOLCE & GABBANA BOUTIQUE - PARIS - FAUBOURG SAINT HONORÉ





DOLCE & GABBANA BOUTIQUE  
PARIS - FAUBOURG SAINT HONORÉ





DOLCE & GABBANA BOUTIQUE - PIAZZA DI SPAGNA, ROMA





DOLCE & GABBANA BOUTIQUE - PIAZZA DI SPAGNA, ROMA







DOLCE & GABBANA BOUTIQUE  
VIA CONDOTTI, ROMA









DOLCE & GABBANA BOUTIQUE - MONACO













LOUIS VUITTON  
BOUTIQUES

ABU DHABI  
BARCELONA  
BERLIN  
ISTANBUL  
KUWAIT CITY  
LONDON  
MILAN  
PRAGUE  
ROME  
ST. PETERSBURG







MONCLER BOUTIQUE, SINGAPORE - MARINA BAY













## FASHION SHOW - PARIS

SS 24 - 26 SEPTEMBER 2023



THE SPRING SUMMER 2024 FASHION SHOW OF THE PRESTIGIOUS, WORLD RENOWN FRENCH BRAND TOOK PLACE IN PARIS, ON SEPTEMBER 26TH THIS YEAR. THE HAUTE COUTURE FASHION BRAND COMMISSIONED BUDRI TO PRODUCE AND INSTALL THE IMPOSING RUNAWAY PAVILLON IN THE HEART OF PARIS, RIGHT UNDER THE TOUR EIFFEL. A PERFECT STUDY BY THE ARTISTIC DIRECTION AND THE ARCHITECTURE STUDIO IN WHICH THE CHOICE OF MARBLES MADE THIS PROJECT AN HARMONIOUS SYMBIOSIS OF SHAPES AND COLOURS.









THE FLOOR AND STAIRS OF THE PAVILLON WERE MADE OF TITANIUM TRAVERTINE, THE VERTICAL COVERINGS, IMPOSING PARALLELEPIPEDS IN GIALLO SIENA, BLACK COSMIC, CONFUSION RED AND GRAY BLUE MARBLES DOMINATED THE SCENE WITH OPEN BOOK MATCHING OF RARE BEAUTY. THE BASSIN D'EAU WITH A MIRROR EFFECT WAS MADE IN BLACK COSMIC ; THE 151 ELEGANT BENCHES FOR THE VIP GUESTS OF THE FASHION SHOW, MONOLITHIC PARALLELEPIPED IN CONFUSION RED, FANTASY AND BLUE ROMA MARBLES, THEY ALMOST BLEND IN WITH THE COVERINGS OF THE STAGE.

BUDRI COMPLETED THE PROJECT IN JUST EIGHT WEEKS AND WAS KEEN IN ACCEPTING THIS CHALLENGE SINCE "WORKING MARBLE IN THE WORLD OF FASHION ALLOWS US TO EXPRESS, THROUGH THIS NOBLE MATERIAL, THE "MAESTRIA" OF WORKING IT LIKE PRECIOUS A FABRIC", STATES GIANMARCO BUDRI.





## HOME INTERIOR DESIGN & CONTEMPORARY DIVISION



“WE INTERPRET CONTEMPORARY CULTURE AND THE EVOLUTION OF HOME DECORATION BY CREATING FURNISHINGS THAT BEAUTIFY INTERIORS, ICONS FOR LOVERS OF FINE DESIGN AND UNIQUENESS”

BUDRI BRINGS THE BRAND’S CORE VALUES OF QUALITY, KNOW-HOW AND STYLE INTO HOME INTERIOR DESIGN, IN A MIX OF DESIGN, INNOVATION AND CREATIVITY. A VISION OF A NEW WORLD IN MARBLE WORKMANSHIP. CRAFTSMAN-LIKE SKILL, EXCLUSIVE DETAILS AND CHOICE OF MATERIALS CHARACTERISE BUDRI’S INTERIOR DESIGNS.

ON THE LEFT: AQUAREL “TARTAN” WALL INLAY - AQUAREL COLLECTION, DESIGN PATRICIA URQUIOLA

ABOVE: AQUAREL “LOW” COFFEE TABLE - AQUAREL COLLECTION, DESIGN PATRICIA URQUIOLA



EXTRAORDINARY BESPOKE EDITION:  
DINING TABLE WITH FISHBONE PATTERN IN PRECIOUS MARBLES AND ONYX.

THE SIZE OF THIS MASTERPIECE IS 6.30 x 1.45 METERS. DUE TO ITS SIZE, THE PROJECT REQUESTED A COMPLEX AND DEDICATED ENGINEERING STUDY. A METICULOUS COLOR AND PATTERN COMBINATION RESULTS IN A HARMONIOUS AND WARM INTERIOR COMPLEMENT, THAT BECOMES THE UNDISPUTED FOCUS OF THE SPACE.



PRIVATE VILLA, DESIGN: STUDIO PATRICIA URQUIOLA





CUSTOM MARBLELACE WALL INLAY - PRIVATE VILLA  
DESIGN: STUDIO PATRICIA URQUIOLA







## MARBLELACE COLLECTION

DESIGN PATRICIA URQUIOLA

“SO I HAVE TRIED TO DOMESTICATE MARBLE’S MIMETIC AND SHIFTING NATURE, BRINGING IT INTO THE REAL OF EVERYDAY EXPERIENCE.” STATES PATRICIA URQUIOLA.

IN THE MARBLELACE COLLECTION, THE OXYMORON “LIGHTNESS OF WEIGHT” TAKES SHAPE, JUXTAPOSING TOTALLY CONTRASTING CONCEPTS: WALL CLADDING OF INTERWOVEN MARBLE CREATE AN IMPRESSION OF FLOWING, SOFT MOVEMENT, AN AIRY CONSISTENCY THAT IS IN CONTRAST WITH THE IMPENETRABLE HARDNESS OF THE MATERIAL. SELF-SUPPORTING MODULAR STRUCTURES BECOME FILTERS, SCREENING LIGHT AND AIR, THAT ARE FAR LIGHTER THAN A SOLID SLAB.







“FIRST EDITION” BESPOKE ARTWORK FOR MASTERBATHROOM.



AQUAREL COLLECTION  
DESIGN PATRICIA URQUIOLA

THE NEW AQUAREL COLLECTION, DESIGNED BY PATRICIA URQUIOLA FOR BUDRI, COMES FROM AN UNUSUAL SYMBIOSIS BETWEEN THE CLASSIC ROMAN TRAVERTINE AND THE IRANIAN WHITE ONYX. AN OUTSTANDING COMBINATION BETWEEN A MATERIAL WIDELY USED IN ARCHITECTURE FOR ITS STRENGTH AND DURABILITY AND THE DELICACY OF WHITE ONYX, INTERPRETED IN THIS COLLECTION IN WATERCOLOR SHADES.

IN A PLAY OF TRANSPARENCIES, AQUAREL EXPRESSES THE WATERCOLOR ‘PAINTING’ IN A CONTEMPORARY MOOD, ENHANCING THE SURFACES OF THE STONE WITH A NEW AND PICTORIAL LANGUAGE.



AQUAREL “PIERCE” LIVING TABLE



ORIGAMI “MIMOSA” COFFEE TABLE  
AQUAREL SPECIAL EDITION

ORIGAMI “AMETHYST” COFFEE TABLE  
AQUAREL SPECIAL EDITION

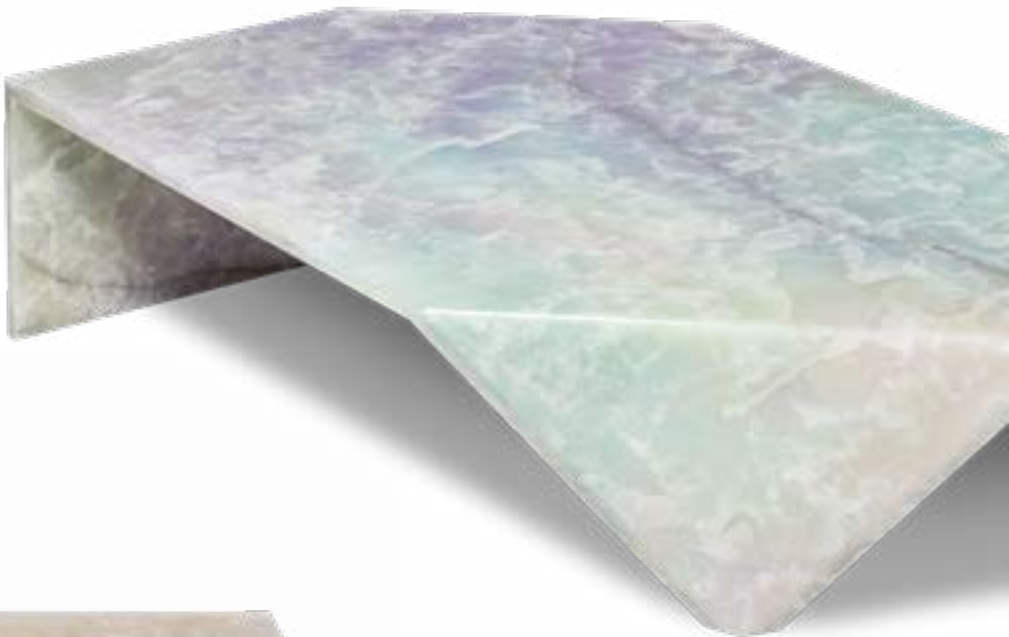

ORIGAMI “QUEEN ELIZABETH II” COFFEE TABLE  
AQUAREL SPECIAL EDITION





AGUA COLLECTION: AQUAREL EDITION

DESIGN PATRICIA URQUIOLA

THE COLLECTION INCLUDES THE MAREA LIVING TABLE, AN EXERCISE OF SOFT AND WARM COLOR SHADES. A SMOOTH PLAY OF PRECIOUS ONYX MATCHED TO THE CLASSIC ROMAN TRAVERTINE. AN INNOVATIVE COMBINATION OF EXTRAORDINARY DIFFERENT MATERIALS THAT LIVE IN PERFECT HARMONY.

FROM THE SAME INSPIRATION COMES THE NEW ALGAS WALL-CLADDING, WITH SINUOUS AND ELEGANT INLAYS IN PINK ONYX, HONEY ONYX, IVORY ONYX, AFGHAN ONYX, RASPBERRY AQUAREL ONYX AND ALBA CHIARA MARBLE ON A THASSOS WHITE MARBLE BACKGROUND.

AGUA “MAREA” LIVING TABLE  
AQUAREL EDITION



AGUA “MAREA” CONSOLE  
AQUAREL EDITION



AGUA “MAREA” COFFEE TABLES  
AQUAREL EDITION



AGUA “ALGAS” WALL CLADDING  
AQUAREL EDITION





MARMOR NATVM COLLECTION

DESIGN GWENAEL NICOLAS - CURIOSITY, TOKYO

MARMOR NATVM, “THE BIRTH OF MARBLE”. DESIGNED BY GWENAEL NICOLAS - CURIOSITY FOR BUDRI, IS A TRIBUTE TO THE POETRY OF NATURE. “NEW MARBLES” COME TO LIFE THROUGH THE COMBINATION OF ADVANCED TECHNOLOGY AND EXCELLENT ITALIAN CRAFTSMANSHIP. THE DESIGNER’S SENSE OF THE COMPOSITION AND RECOMPOSITION GRANTS THE STONE A NEW SHAPE, A NEW ENERGY, A NEW LIFE. AN EXPLOSION OF EXTREMELY DETAILED AND TINY MARBLE INLAYS, APPEAR LIKE BRUSH STROKES, AND THE SOPHISTICATED PROCESSING SEEMS TO DISAPPEAR. BLACK AND WHITE MARBLES MOVE WITH ELEGANCE AND LIGHTNESS TRANSCENDING THE CONCEPT OF A NATURAL HARD MATERIAL.

THE COLLECTION IS DESIGNED FOR RESIDENCIES AS WELL AS CONTRACT PROJECTS.







## FRAGMENT COLLECTION

DESIGN GWENAELE NICOLAS

FRAGMENT COLLECTION, DESIGNED BY GWENAELE NICOLAS, CURIOSITY STUDIO - TOKYO, IS A HYMN TO THE "LIGHTNESS" OF MARBLE THANKS TO THE INNOVATIVE BUDRI SLIM MARBLE.

FRAGMENT - THE NAME ITSELF - TELLS ITS ESSENCE. IN FACT, IT WAS BORN FROM THE IDEA OF REUSING THIN FRAGMENTS OF DIFFERENT WIDTHS AND LENGTHS AND THICKNESSES FROM MOSAIC RODS AS WELL AS FROM SLABS DERIVING FROM THE MANUFACTURING PROCESS. JUXTAPOSED AND MERGED WITH A COMPONENT, PATENTED BY THE COMPANY, THAT MAKES THEM EXTREMELY RESISTANT, THEY FORM LONGITUDINAL AND HORIZONTAL PATTERNS OF MONOCHROMATIC OR MULTICOLORED SHADES. THE COLLECTION COMBINES COLOR VARIATIONS IN SHADES OF WHITE AND GREY AND A MULTICOLOR VERSION WITH A "FABRIC EFFECT".

"LIKE THE JAPANESE MIKADO - THE GAME THAT IS CHARACTERIZED BY ITS COLORED STICKS - FRAGMENT IS A "FREE FALL OF COLOR" "COMBINED WITH THE RIGOR OF SHAPES, TYPICAL OF JAPANESE CREATIVITY. A FOUR-HANDED WORK OF THE DESIGNER AND THE COMPANY THAT ALLOWS TO REVIVE 'SLEEPING' MATERIALS COMBINED WITH THE LUXURY OF LIGHTNESS".

BAKODO SIDE TABLES







## VANITEUX COLLECTION

THE EMPEROR NAPOLEON LOVED LUXURY AND WEALTH. HIS VANITY AND ENORMOUS EGO WERE REFLECTED IN EVERYTHING THAT SURROUNDED HIM, HIS LAVISH RESIDENCES DOMINATED BY MARBLE, SILK, BROCADE AND GOLD.

NOT EVEN DURING HIS LONG VOYAGES AND MILITARY CAMPAIGNS DID HE COMPROMISE ON LUXURY, ASKING HIS TRUSTED ARTISANS - INCLUDING GOLDSMITHS, BLACKSMITHS, UPHOLSTERERS, MARBLE WORKERS AND CARPENTERS - TO CREATE ELEGANT TABLES, MIRRORS, CONSOLE TABLES AND PADDED FURNITURE THAT EXUDED BEAUTY AND COULD BE EASILY TRANSPORTED.

THE “VANITEUX” COLLECTION, DESIGNED BY VIZZINI, IS INSPIRED BY THESE KINDS OF LUXURY FURNISHINGS AND UNDOUBTEDLY DOMINATED BY PICTORIAL MARBLE, UNIQUE AND EYE-CATCHING IN ITS LIGHTNESS.

SIMPLE, GEOMETRIC SHAPES, COMPLETELY HARMONIOUS WITH THE WARM SHADES OF MARBLE, BECOME HIGHLY VERSATILE TABLE-A-PLATEAU AND TRAYS, SUPPORTED BY ELEGANT PLANTS.





## CASE STUDY: THE MEDITERRANEAN PEARL

THE IMPOSING PALACE STANDS IN ISRAEL, ON THE FERTILE LAND OF THE JORDAN RIVER, A FEW METERS FROM THE MEDITERRANEAN SEA. IT TOOK THREE YEARS OF CEASELESS WORK TO COMPLETE THE MOST COMPLEX WORK CARRIED OUT BY BUDRI IN 62 YEARS OF ACTIVITY. THE PROPERTY, CONSISTING OF THE MAIN BUILDING, THE ADJACENT SPA BUILDING AND THE GUEST HOUSE, COVERS A LIVING AREA OF 13000 M<sup>2</sup>. THE PALATIAL RESIDENCE (SPANNING 6400 M<sup>2</sup> - 69000 SQUARE FEET) BOASTS NUMEROUS EN-SUITE BEDROOMS AND LUXURY BATHROOMS, A SPA, GYM, INDOOR AND OUTDOOR POOLS, A WINE CELLAR, BILLIARD ROOM, HOME CINEMA AND OTHER AMENITIES.

IT IS, BY FAR, THE MOST EXPENSIVE VILLA OVERLOOKING THE MEDITERRANEAN SEA, A REAL PEARL.

THE PALACE HAS ABUNDANT DECORATIONS OF HIGH COMPLEXITY, ALL DIFFERENT FROM EACH OTHER AND IN PERFECT HARMONY WITH THE STYLE OF EACH INTERIOR. AN ABSOLUTE MASTERPIECE, IN WHICH MARBLES, ONYXES AND SEMIPRECIOUS STONES SHOW OFF AMAZING RICHNESS AND COLORS.

BUDRI WAS ENTRUSTED WITH THE ENTIRE CONTRACT FOR THE PROCESSING OF MARBLE, ONYX AND SEMIPRECIOUS STONES, THE INTERIORS, THE EXTERIORS, INCLUDING THE MOSAIC POOLS, THE TURKISH BATH, THE FOUNTAINS, THE STATUES AND THE COLUMNS.

AMONG THESE, THE TWO MOST IMPRESSIVE ARE THE TWO COLUMNS IN CALACATTA VIOLA MARBLE IN THE MAJESTIC GRAND HALL. WITH AN HEIGHT OF 6 METERS, THEY WERE PROCESSED, ON REQUEST OF THE CUSTOMER, IN A SINGLE PIECE. THE COMPLEXITY OF THE CONSTRUCTION AND ABOVE ALL OF THE INSTALLATION REQUIRED THE USE OF A SPECIAL HELICOPTER TO INSERT THE COLUMN INTO THE FOUNDATIONS. THE COLUMNS' CAPITAL IS ENTIRELY COVERED WITH 24 CARAT GOLD.

THE BUILDING IS SURROUNDED BY A LARGE PARK WITH FOUNTAINS, OBELISKS AND PAVILLONS FROM WHICH, LIKE A PAINTING, THE MAJESTIC SWIMMING POOL WITH ARTISTIC MOSAIC BACKDROP EMERGES, FURTHER ENRICHED BY THE SURROUNDING PAVEMENT, AN INLAY REPRESENTING A BLOOM OF FLOWERS.

THE INDOOR POOL IN THE SPA BUILDING, IN ARTISTIC MOSAIC, HIGHLIGHTS A SEABED COVERED WITH SHELLS AND CORALS, AS THE FLOORING AND COVERINGS THAT SURROUND THE SAME POOL.





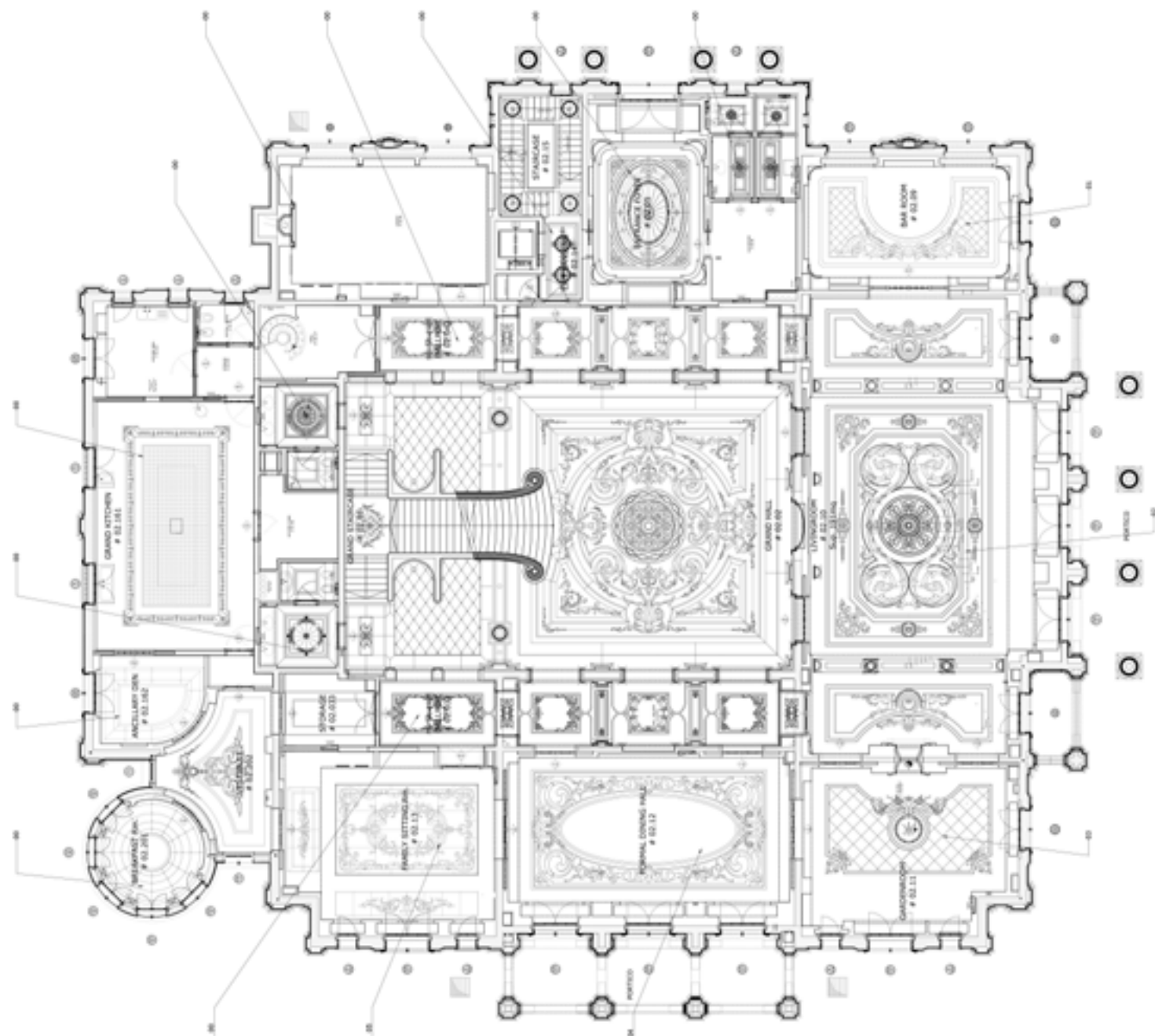







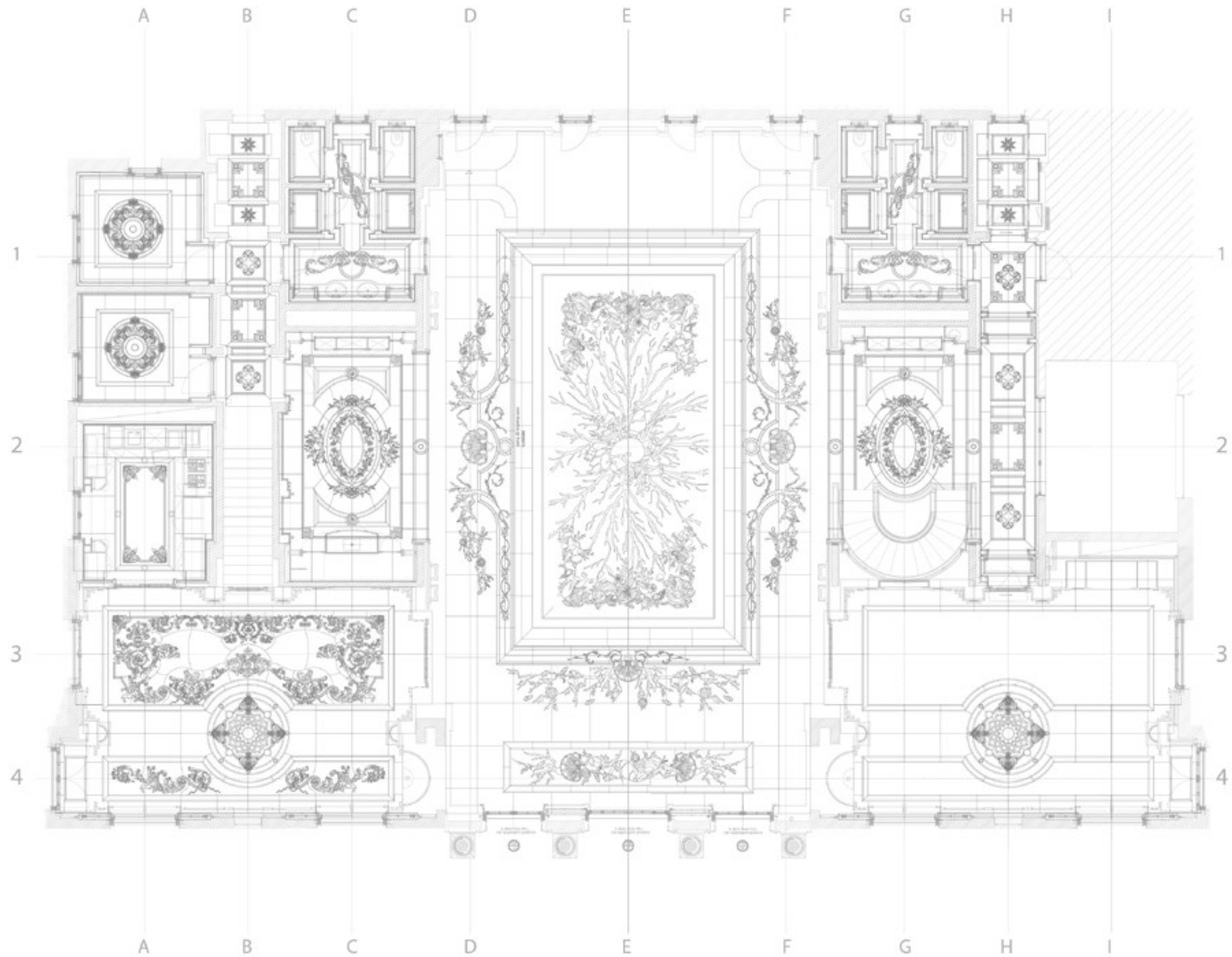









## YACHTING DIVISION

DEEP KNOWLEDGE AND OUTSTANDING CRAFTSMANSHIP. THESE ARE THE KEY ASSETS THAT ALLOW US TO GO BEYOND THE CONCEPT OF THE MATERIAL'S HEAVINESS AND RIGIDITY, CREATING LIGHTNESS WHERE IT SEEMS IMPOSSIBLE. BUDRI'S YACHTING DIVISION BLENDS LUXURY AND INNOVATIVE, METICULOUS DESIGN, A COMBINATION THAT MAKES BUDRI CREATIONS RECOGNIZABLE FOR THEIR ENDURING BEAUTY AND UNIQUENESS.

OUTSTANDING CRAFTSMANSHIP AND CUTTING-EDGE TECHNOLOGY AT THE SERVICE OF THE DESIGNER.

MAJOR INVESTMENT IN TECHNOLOGICAL INNOVATION AND YEARS OF RESEARCH IN THE FIELD OF 'SLIM MARBLE' ALLOW BUDRI TO PRODUCE CREATIONS WITH REDUCED WEIGHT, RESULTING IN A LOWER ENVIRONMENTAL IMPACT AND AN EASIER INSTALLATION PROCESS.

### MAIN YACHTING PROJECTS

- REGINA D'ITALIA CODECASA  
PRIVATE CUSTOMER MY 65 MT. 2019
- ROYAL CARREBEAN LOUNGE AREA
- AMELS MY 62  
MT 2019 PRIVATE CUSTOMER
- PRIVATE YACHT MY 125  
MT 2019 REFIT
- LIBERTY NILE EGYPT CRUISE SHIP

\* DUE TO THE EXPRESS WISHES OF OUR COSTUMERS AND FOR REASONS OF CONFIDENTIALITY, IMAGES OF PRESTIGIOUS MARBLE INTERIORS OF THIS DIVISION MAY NOT BE PUBLISHED AND THE NAMES OF THE PROPRIETORS WITHHELD

REFERENCES PAGE 158



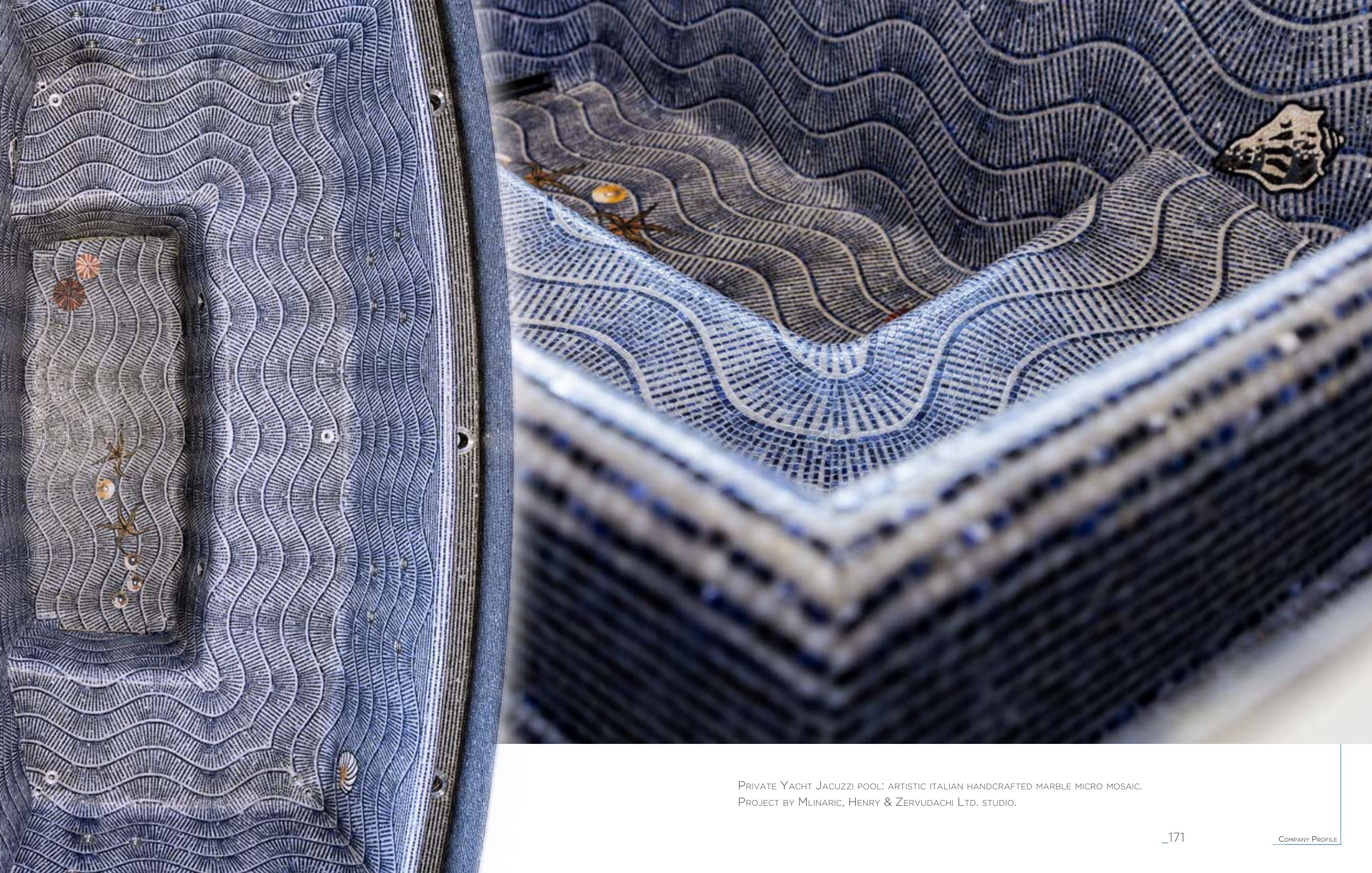

PRIVATE YACHT JACUZZI POOL: ARTISTIC ITALIAN HANDCRAFTED MARBLE MICRO MOSAIC.  
PROJECT BY MLINARIC, HENRY & ZERVUDACHI LTD. STUDIO.



A SPECIAL PROJECT: TWO JACKETS  
MADE OF THOUSANDS OF HAND

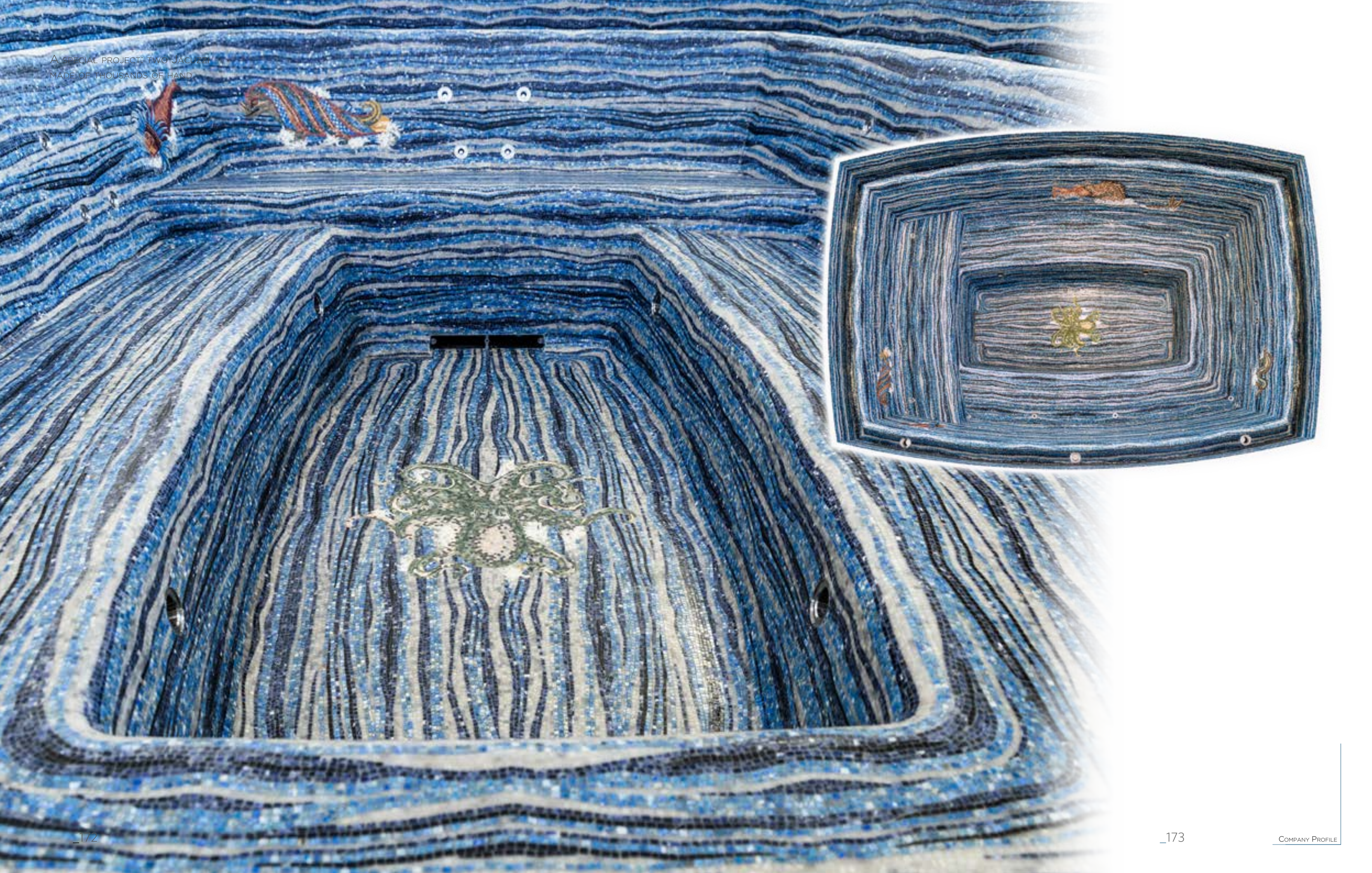



THE BUDRI EYEWEAR COLLECTION IS A TRIBUTE TO LIGHTNESS AND A PIONEERING DEVELOPMENT IN THE USE OF MARBLE: THIS RARE, EXQUISITE MATERIAL BECOMES A WAFER-THIN SURFACE, SHAPED BY SKILLED CRAFTSMANSHIP AND FINE TECHNOLOGIES TO FORM LUXURY EYEWEAR WITH A PERFECT FIT.

BUDRI EYEWEAR FRAME: DONATELLO CONCORDIA ON TRIC TRAC WRIST BAG BY VALEXTRA



## BUDRI MARBLE EYEWEAR

THE ORIGINAL IDEA CAME ABOUT, ALMOST BY MAGIC, IN AUGUST 2011 IN THE BUDRI WORKSHOPS DURING THE PRODUCTION OF NAT|F|USE - THE COLLECTION CREATED IN COLLABORATION WITH THE DESIGNER PATRICIA URQUIOLA. A PIECE OF MARBLE WAS DROPPED BY ACCIDENT AND THE SHAPE OF THE RESULTING FRAGMENT RESEMBLED THE FRONT OF A FRAME. THIS HERALDED THE START OF AN INCREASINGLY AMBITIOUS, BOLD AND SENSATIONAL CHALLENGE: TO FORGE MARBLE INTO A WEARABLE ACCESSORY AND TO MAKE IT TECHNICALLY SUITED TO ACCOMMODATING SUN AND PRESCRIPTIVE LENSES.



BUDRIEYEWEAR.COM





BUDRI EYEWEAR CAPSULE COLLECTION FRAME: CANOVA SUAVITAS ON ISIDE KIMONO BAG BY VALEXTRA

BUDRI PRESENTED THE FIRST PROTOTYPES EARLY IN 2014, MAKING IT THE PRECURSOR OF A TREND IN THE EYEWEAR INDUSTRY, WHICH IS INCREASINGLY TURNING ITS ATTENTION TO THE POTENTIAL USE OF UNUSUAL, INNOVATIVE MATERIALS. IN THE SAME YEAR A DEVASTATING EARTHQUAKE STRUCK THE ENTIRE DISTRICT TO THE NORTH OF MODENA, DELAYING THE PROJECT THAT HAD BEEN ENTHUSIASTICALLY PROMOTED AND SUPPORTED BY GIANMARCO BUDRI.

IN THE MONTHS THAT FOLLOWED HE THEREFORE DEVOTED HIS ENERGY TO REBUILDING THE COMPANY AND GETTING THE EYEWEAR PROJECT BACK ON TRACK, COMBINING THE OUTSTANDING WORKMANSHIP WITH THE KNOW-HOW AND GENIUS OF DESIGNER VALERIO COMETTI, AS WELL AS THE EXPERTISE OF SOME OF THE BIGGEST NAMES IN THE EYEWEAR INDUSTRY.

AFTER TWO YEARS OF PAINSTAKING RESEARCH, CULMINATING IN THE IN-HOUSE DEVELOPMENT OF A SPECIFIC PRODUCTION TECHNOLOGY, BUDRI LAUNCHES THE EXCLUSIVE AND REVOLUTIONARY GENIUS EYEWEAR COLLECTION CREATED IN MARBLE, ONYX AND SEMI-PRECIOUS STONES.

**THE BUDRI EYEWEAR GENIUS COLLECTION** COMPRISES FIVE MODELS WHOSE NAMES ARE A CLEAR TRIBUTE TO THE ART OF ITALIAN SCULPTURE AND ITS GREATEST EXPONENTS: DONATELLO, BERNINI, MICHELANGELO, CANOVA AND PALLADIO. PROPOSED IN NINE VARIETIES OF MARBLE FROM THE WORLD’S FINEST QUARRIES, INCLUDING AMAZONITE FROM PATAGONIA, PORTORO FROM THE GULF OF LA SPEZIA AND PRECIOUS LAPIS LAZULI FROM SOUTH AFRICA.



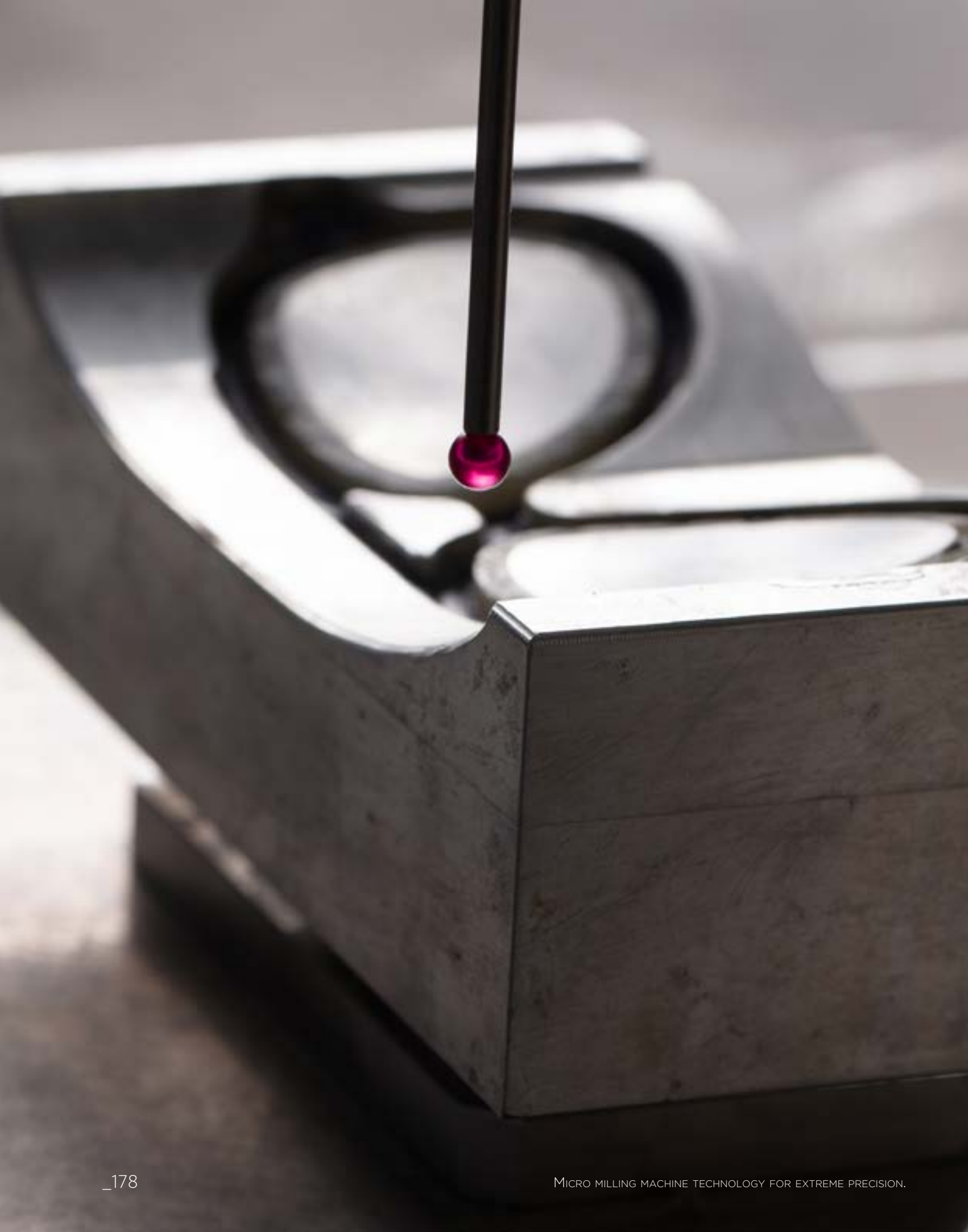

## RESEARCH & DEVELOPMENT DIVISION



OUR DIVISION DEDICATED TO RESEARCH & DEVELOPMENT WAS CREATED TO GENERATE NEW APPLICATIONS IN STONE PROCESSING.

BUDRI INVESTS AND FIRMLY BELIEVES IN TECHNOLOGICAL INNOVATION TO GUARANTEE HIGHLY COMPLEX PRODUCTION CAPACITIES. SOPHISTICATED SYSTEMS AND LATEST GENERATION MICRO MILLING MACHINES ALLOW PROCESSING ON SURFACES OF TENTHS OF A MILLIMETER THICKNESS.

THE DEPARTMENT OFFERS CONSULTANCY AND DESIGN FOR SPECIAL COMPLEMENTS AND ACCESSORIES IN MARBLE AND SEMI-PRECIOUS STONES. A TRIBUTE TO LIGHTNESS, AN EXTRAORDINARY EVOLUTION IN STONE PROCESSING: THE MATERIAL BECOMES A MILLIMETER SURFACE, SHAPED BY SOPHISTICATED TECHNOLOGIES AND SKILLED CRAFTSMANSHIP. FROM THE JEWELLERY SECTOR TO SPECIAL CUSTOM-MADE PROJECTS.



OUR **R&D DIVISION** HAS THE ABILITY AND FLEXIBILITY TO TACKLE A NEW PROJECT FROM ITS ORIGIN, FROM A DESIGNER'S CONCEPT OR FROM AN ALREADY EXISTING DESIGN OBJECT, ORIGINALLY MADE WITH A DIFFERENT MATERIAL. BUDRI PROVIDES INTERNALLY TO:

- \_ FEASIBILITY STUDY;
- \_ CHOOSING THE TYPE OF TECHNOLOGY SUITABLE FOR THE MANUFACTURING PROCESS;
- \_ CAD ENGINEERING BASED ON THE GEOMETRIC COMPLEXITY OF THE PRODUCT;
- \_ STUDY OF POSSIBLE COMBINATIONS OF MATERIALS RESPECTING THE TOLERANCES;  
WITH OTHER AESTHETIC AND/OR FUNCTIONAL ELEMENTS;
- \_ PROTOTYPE CREATION;
- \_ SUITABILITY TEST FOR PLACING THE PRODUCT ON THE MARKET;
- \_ SUPPORT BUDRI TO MAKE IMPROVEMENTS  
WHERE NECESSARY;
- \_ START OF PRODUCTION.



THE MARVLES COLLECTION IS A COLLABORATION BETWEEN VALEXTRA, AN ITALIAN COMPANY IN THE LUXURY LEATHER GOODS SECTOR, AND BUDRI.

THE COLLECTION INCLUDES THE REALIZATION OF HANDLES AND CLIPS FOR BAGS. THE INLAYS THAT MAKE UP THE DESIGNS ARE MILLIMETER IN SIZE, THE THICKNESS IS 1.5 MM. THE INLAY IS ASSEMBLED ON A CHAMPAGNE METAL TRAY.

IN THIS IMAGE, THE FUSION HANDLE, MADE OF FIOR DI PESCO, NERO MARQUINIA, ROSA EGEO AND BIANCO CARRARA MARBLES.







PICTURE BY COURTESY OF © GESSI S.p.A. - 2023

BESPOKE INLAID MARBLE SPHERES FOR GESSI HAUTE COUTURE'S  
COLLECTION "PERLE", PRESENTED DURING THE MILAN DESIGN WEEK 2023.







PROJECT FOR THE CREATION OF EXTRA-SMOOTH STONES FOR THE TAPS SECTOR.

MADE OF FOREST BROWN, BIANCO CARRARA, NERO MARQUINIA AND PIETRA DI FOSSENA, THEY ARE PROVIDED WITH A GROOVE THAT ALLOWS THE ASSEMBLAGE OF THE TAP, IN FULL COMPLIANCE WITH THE MECHANICAL TOLERANCES IMPOSED BY THE CUSTOMER.

FLATWARE WITH NERO PORTORO MARBLE HANDLES AND PINK GOLD METAL FINISHING.





A SPECIAL COLLABORATION WITH CODICEICONA, AN ITALIAN BRAND KNOWN FOR ITS EXCEPTIONAL DESIGN OF SPECIAL ACCESSORIES, HAS LED TO THE CREATION OF FERMAT, AN EXTREMELY TECHNOLOGICAL AND PERFORMING PROJECT, HIDDEN IN A CONTEMPORARY MARBLE SCULPTURE. HARMONIOUS PROPORTIONS AND CAREFUL PROCESSING OF EVERY DETAIL HAVE GIVEN RISE TO A BLUETOOTH SPEAKER AND MOBILE DEVICE CHARGER WITH INTEGRATED COURTESY LIGHT.







## FASHION DESIGN

“WITH SOPHISTICATED NEW TECHNOLOGIES, BUDRI SUCCEEDED IN MAKING THE IMPOSSIBLE REALITY: MARBLE IS MADE INCREDIBLY THIN, LIGHT AND STRONG, BECOMING HANDLES AND CLIPS FOR THE ISIDE, A WONDROUS FUNCTIONAL ADDITION TO AN ICONIC BAG. THANKS TO BUDRI’S INCREDIBLE KNOW-HOW AND THE EXPERIENCE AND TECHINICAL INNOVATIONS OF ITS R&D DEPARTMENT, BUDRI IS ABLE TO MAGICALLY MANIPULATE MARBLE IN MINIATURE SCALE, SOMETHING THAT HAS NEVER BEEN DONE BEFORE.”

SARA FERRERO - CEO VALEXTRA





VALEXTRA PRESENTS MARVLES: A MULTIDISCIPLINARY PROJECT IN COLLABORATION WITH INTERNATIONALLY ACCLAIMED DESIGNER AND ARCHITECT PATRICIA URQUIOLA AND MARBLE MASTERS BUDRI, RESULTING IN A UNIQUE BLEND OF CRAFTSMANSHIP AND TECHNOLOGY.

THIS PROJECT COMES FROM A REMARKABLY MILANESE DIALOGUE BETWEEN THREE VISIONARY WOMEN: VALEXTRA CEO SARA FERRERO, ALESSANDRA BUDRI AND PATRICIA URQUIOLA, WHO WORKED TOGETHER MIXING CREATIVITY, CULTURE, CRAFTSMANSHIP AND TECHNOLOGY. THE PROJECT COMPRISES THREE COLLECTIONS, EACH FEATURING A DISTINCTIVE LEATHER INTARSIA DESIGN, A NEW MARBLE HANDLE AND A MARBLE CLASP. THE FUSE, WITH ORGANIC CURVES THAT SUGGEST ROCK FORMATION; THE BOW, CHARACTERIZED BY A PLAY OF GEOMETRIES THROUGH INTERSECTING ARCHES; AND THE EDGE, AN EXTREME ANGULAR MOTIF THAT IS PART FUTURIST, PART ART-DECO. THE WHOLE COLLECTION WAS DEEPLY INSPIRED BY AGATE, AND ITS NATURAL LAYERS WERE REPRODUCED IN MARBLE.



MARVLES ISIDE BAG - BUDRI FOR VALEXTRA

MARVLES



# Worldwide references

- Australia**
  - › Private Villa Melbourne
  - › Paspaley Boutique, Sydney
- Azerbaijan**
  - › Private Villa Baku
  - › Dolce & Gabbana Baku
- Bahrain**
  - › Private Villa
  - › YSL Boutique
- Belgium**
  - › YSL Boutique, Bruxelles
- Cambodia**
  - › Private Villa Phnom Penh
- China**
  - › Private Villa Beijing D 18
  - › Piaget Boutique - Shenzhen
  - › Givenchy - Shenzhen
- Congo**
  - › Domaine Presidentiel
- Croatia**
  - › Hotel Briig Split
- Czech Republic**
  - › Louis Vuitton Prague
- Ecuador**
  - › Private Villa for the Italian Embassy Quito
- Egypt**
  - › Private Villa, Cairo
  - › 3 Holiday Cruisers «The Queen of Thebes», Luxor
- France**
  - › Hotel Martinez, Cannes
  - › Private Apartment - Av. Montaigne, Paris
  - › Private Villa, Antibes
  - › Cartier Boutique, Cannes
  - › Sergio Rossi Boutique, Paris
  - › Gian Vito Rossi Boutique, Paris
  - › Dolce & Gabbana Boutique, Paris
  - › Dolce & Gabbana Boutique, Paris - Faubourg
  - › Dolce & Gabbana Cannes
  - › Private Spa, Courchevel
  - › Private Villa, Cap Ferrat
  - › Private Villa, Roquebrune
  - › Pavillon for YSL Runaway Show, Paris
  - › YSL Boutique, Paris
  - › RH Restaurant, Paris
- Germany**
  - › Boris Fuchsmann’s Residence Düsseldorf
  - › Obermeier Baeder GmbH
  - › Private Villa Berlin
  - › Louis Vuitton Boutique Berlin
  - › MarienTurm Suite Lounge Bar Frankfurt
  - › BMW Design Welt Muenchen
- Greece**
  - › Mr. Costantino’s Legal Offices Athens
  - › Private Cruiser for Golden Shipmanagement Ltd. Vouliagmeni
- Hong Kong**
  - › Givenchy Boutique
  - › Private Villa and Office Mount Nicholson
  - › Private Villa
- Hungary**
  - › Grand Royal Hotel Corinthia, Budapest
  - › Private Villa, Budapest
- India**
  - › Private Villa, Bangalore
- Indonesia**
  - › Private Villa, Jakarta
  - › Moncler Boutique, Singapore
- Ireland**
  - › 4 Fitness Centers for «International Leisure Group», Dublin
- Israel**
  - › Private Villa, Tel Aviv
  - › Private Villa, Cesarea
  - › Private Apartment, Tel Aviv
- Italy**
  - › Villa Alessandrini, Modena
  - › 7 Private Villas - Costa Smeralda, Sardinia
  - › Alghero Airport, Sardinia
  - › Grand Hotel «Molino Stucky», Venice
  - › Hotel Four Season, Milan
  - › Louis Vuitton Boutique, Venice
  - › Louis Vuitton Boutique, Rome
  - › Gian Vito Rossi Boutique, Milan
  - › Santoni Boutique, Milan
  - › Dolce & Gabbana Boutique, Venice
  - › Givenchy Botique, Rome
  - › Dolce & Gabbana Boutique, Via Condotti Rome
  - › Dolce & Gabbana Boutique, Via della Spiga Milan
  - › Dolce & Gabbana Boutique, C.so Venezia Milan
  - › Dolce & Gabbana Milan - Via Kramer, Offices Building
  - › Dolce & Gabbana Milan - Via Bellotti, Offices Building
  - › Louis Vuitton Boutique, Milan
  - › Moncler Boutique, Milan
  - › Private Villa, Portofino
  - › Private Villa, Ferrara
  - › Private Villa, Modena
  - › Private Yacht, Codecasa 65-F74
  - › Tod’s Boutique, Via Montenapoleone Milan
  - › Boutique Palazzo Avino, Ravello
  - › Private Apartment, Via Fiori Oscuri Milan
  - › Private Apartment, Via Fratelli Gabba Milan
  - › Private Apartment, Via della Moscova Milan
  - › Private Apartment, Via Tasso Milan
  - › Private Apartment, Piazza Castello Milan
  - › Private Apartment, Via Bigli Milan
  - › Private Apartment, Via Manzoni Milan
  - › Private Apartment, Foro Buonaparte Milan
  - › Private Apartment, Via Pisacane Milan
  - › Private Apartment, Piazza Castello Milan
  - › Private Apartment, Brescia
  - › Private Villa, Forte dei Marmi
  - › Private Villa, Portofino
  - › Private Villa, Santa Margherita Ligure
  - › Private Villa, Selva di Val Gardena
  - › Private Villa, Pescara
  - › Louis Vuitton Boutique, Forte dei Marmi
  - › Louis Vuitton Boutique, Venezia
  - › Audemars Piguet Boutique, Milan
  - › YSL Boutique, Venezia

Budri creations are installed by the company’s own laying teams in all five continents.  
Due to the expressed wishes of our customers and for reasons of confidentiality many images of prestigious projects have not been published and the names of the proprietors withheld.

- Japan**
  - › Hermès Boutique Kob, - Shin & Takashimaya
  - › Osaka Airport
  - › Hermès Boutique, Kōbe
  - › Hermès Boutique, Shin
  - › Dolce & Gabbana Boutique, Osaka
- Kuwait**
  - › Louis Vuitton Boutique, Kuwait City
- Maldives**
  - › Resort Velaa, Maldives
- Montenegro**
  - › Private Villa, Montenegro
- Netherlands**
  - › YSL Boutique, Amsterdam
- Nigeria**
  - › Private Villa, Lagos
- Norway**
  - › Louis Vuitton Boutique, Oslo
- Palestine**
  - › Hotel Casino, Jericho
- Panama**
  - › Dolce & Gabbana Boutique, Panama City
- Principality of Monaco**
  - › Dolce & Gabbana Boutique, Monte Carlo
  - › Tasaki Monte Carlo
- Qatar**
  - › Private Villa «Her Royal Highness the Princess of Qatar», Doha
  - › D&G Place Vendome Doha
  - › Givenchy Place Vendome Doha
- Russia**
  - › Complex of 6 Private Villas and Wellness Centre, Moscow
  - › Residential and Business Centre Koperniko, Moscow
  - › Private Villa, St. Petersburg
  - › Private Villa GB Group, Nazarovo
  - › Private Apartment, Moscow
  - › Private Villa, Moscow
  - › Private Villa, Novosibirsk Siberia
  - › Tiffany Boutique, Moscow
  - › Louis Vuitton Boutique, St. Petersburg
  - › Private Villa, St. Petersburg
  - › Dolce & Gabbana Boutique, Moscow
- Saudi Arabia**
  - › Private Villa for Saudi Emir Riyadh
  - › Dolce & Gabbana Home Boutique, Jeddah
- Singapore**
  - › Piaget Boutique
  - › Louis Vuitton Boutique (Furniszhing supply)
- Spain**
  - › Private Villa «L. D.» Marbella
  - › Private Villa «L.» Marbella
  - › Private Villa «M.» Marbella
  - › Private Villa «G.» Marbella
  - › Private Villa «B.» Marbella
  - › Louis Vuitton Boutique, Barcelona

- South Korea**
  - › Private Place of Worship, Seoul
  - › Cheonwon Palace, South Korea
- Switzerland**
  - › Private Villa «Al Hana», Genève
  - › Hotel «La Reserve», Genève
  - › Neue Atlantis Hotel, Zurich
  - › Private Attic Floor, Zurich
  - › Private Villa, Lugano
  - › Private Villa, Geneve
- Turkey**
  - › Louis Vuitton Boutique, Istanbul
- Ukraine**
  - › Private Villa, Kiev
- United Arab Emirates**
  - › Sheikh Zayed Bin Sultan Al Nahyan Mosque Abu Dhabi
  - › Dolce & Gabbana Dubai
  - › Louis Vuitton Boutique Abu Dhabi
- United Kingdom**
  - › Private Villa for Saudi Emir Hyde Park, London
  - › Private Villa for Saudi Emir Saint George, London
  - › Private Villa for Saudi Emir Charles Street, London
  - › Private Villa for FPPM Paris Saint Kean, London
  - › Greenwich Park Bar & Grill for Greenwich Inc., London
  - › Flos-Moroso Showroom, London
  - › Shizaru Gallery 112 Mount St Mayfair, London
  - › Private Villa «Debenham House», London
  - › Private Villa Mayfair, London
  - › Private Villa Holland Park, London
  - › Private Mansion Mayfair, London
  - › Bentley Home Boutique, London
  - › Dolce & Gabbana Boutique, Old Bond Street - London
  - › Louis Vuitton Boutique, London
  - › MSGM Boutique, London
  - › Moncler Boutique, London
  - › Canali Boutique, London
  - › Private Villa, London
  - › Private Apartment, London
- USA**
  - › Casino Hotel Wynn, Las Vegas
  - › Golf Club, Miami
  - › Private Luxury Home, New York
  - › Gian Vito Rossi Boutique, New York
  - › Private Villa, San Francisco
  - › Moncler Boutique, New York
  - › Moncler Boutique, Miami
  - › Moncler Boutique, Chicago
  - › Dolce & Gabbana Boutique, Miami
  - › Dolce & Gabbana Boutique, Atlanta
  - › Dolce & Gabbana Boutique, Dallas
  - › Dolce & Gabbana Boutique, Las Vegas
  - › Private Apartment, San Francisco
- Uzbekistan**
  - › Dolce & Gabbana Home Boutique, Tashkent



# COLLABORATIONS

BULGARI  
CARTIER  
CÉLINE  
DOLCE & GABBANA  
FENDI CASA  
FRATELLI ROSSETTI  
GESSI  
GIANVITO ROSSI  
GIVENCHY  
HERMÉS  
LALIQUE  
LOUIS VUITTON  
MONCLER  
MSGM  
PASPALEY  
PIAGET  
PRADA  
SANTONI  
SERGIO ROSSI  
TIFFANY & CO.  
VALEXTRA  
YVES SAINT-LAURENT



## BUDRI SRL

FACTORY & HEADQUARTERS  
VIA DI MEZZO 65  
41037 MIRANDOLA (MO) - ITALY  
T +39 0535 21967  
INFO@BUDRI.COM

## BUDRI MILANO

SHOW-ROOM ENTRANCE  
FORO BUONAPARTE 60  
20121 MILANO - ITALY  
T +39 02 87252558  
BUDRIMILANO@BUDRI.COM

 @BUDRIITALIANMARBLEINLAY  
 @BUDRI\_OFFICIAL  
 BUDRI.COM  
MESTIERIGRUPPO.COM

A  **MESTIERI** COMPANY

PUBLISHED IN JANUARY 2024